

PLAT OF SURVEY

OF PROPERTY OF

DESCRIBED AS FOLLOWS *Lot 8 and South 1/2 Lot 9, Block 4, Effon Grove Plat 2,
No. 1698 Edgerton Street Ramsey County, Minn.*

SCALE: 1 INCH 30 FEET

T. J. WELCH, REGISTERED SURVEYOR
738 SURREY AVENUE ST. PAUL, MINN.

NORTH

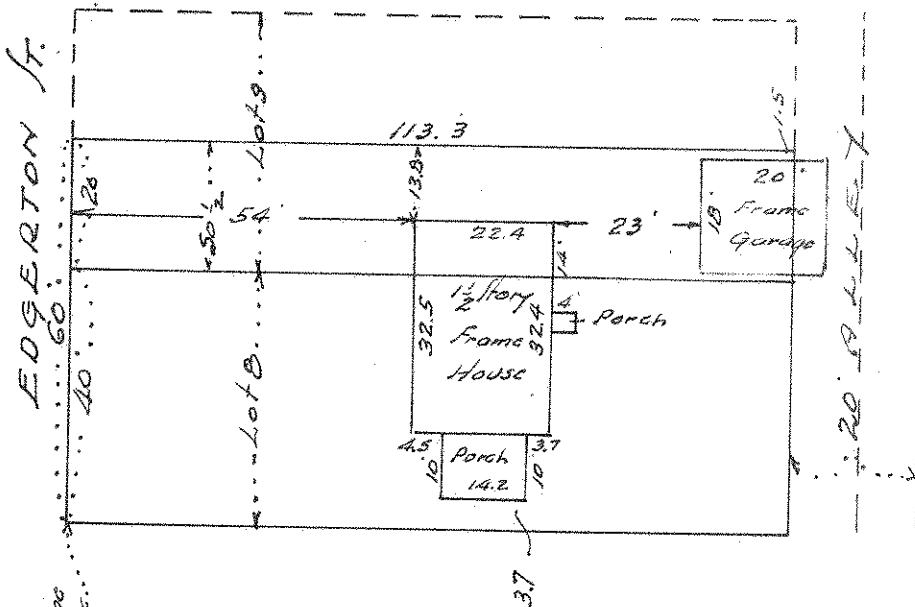

155 ft. to the North Line of Carpenter Ave.

CERTIFICATE OF SURVEY

I hereby certify that on July 27 1944

I surveyed the property described above and that the above plat is a correct representation of said survey.

T. J. Welch

SCANNED ON

