

Loan 7261

PR 6-0640
TELEPHONE TOWER 0640

PLAT OF SURVEY

OF PROPERTY OF Cyril J. and Fern A. McDonald

DESCRIBED AS FOLLOWS Lots 27 and 28, Block 3, Upton Grove 2nd Plat
Nº 606 Kingston Ave., Ramsey County, Minnesota

SCALE: 1 INCH = 30 FEET

T. J. WELCH, REGISTERED SURVEYOR
736 SURREY AVENUE, ST. PAUL 6, MINN.

KINGSTON AVE.

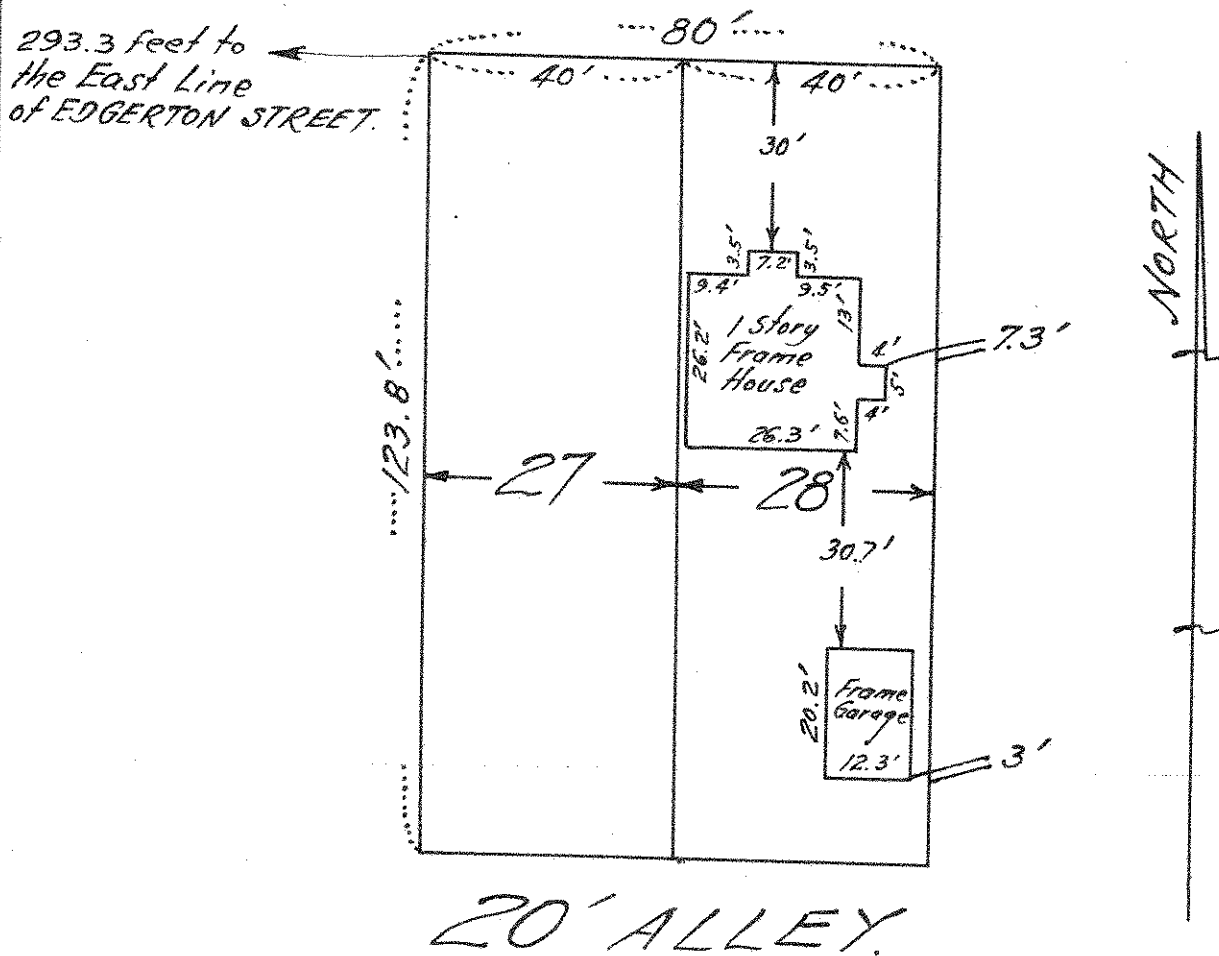

CERTIFICATE OF SURVEY

I hereby certify that on 1-24 19 59

I surveyed the property described above and that the above plat is a correct representation of said survey.

J. J. Welch