

Appl. 29613

TELEPHONE PR 6-0640

# PLAT OF SURVEY

OF PROPERTY OF Robert J. Curtis  
 DESCRIBED AS FOLLOWS Lot 13 Block 5, Skidmore's Addition  
No 1008 East 4th Street, St. Paul, Minn.

SCALE: 1 INCH = 30 FEET

T. J. WELCH, REGISTERED SURVEYOR  
738 SURREY AVENUE, ST. PAUL 6, MINN.

EAST 4<sup>TH</sup> ST.

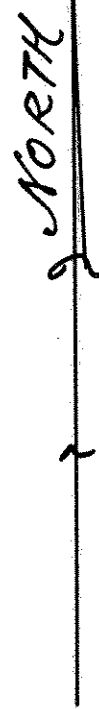
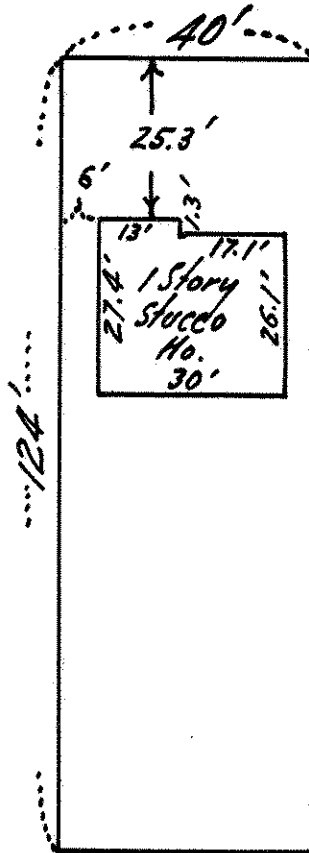

20' ALLEY

### CERTIFICATE OF SURVEY

I hereby certify that on 9-16, 1959  
 I surveyed the property described above and that the above  
 plat is a correct representation of said survey.

T. J. Welch