

FROM THE OFFICE OF

# CHARLES O. GEORGI COMPANY

2215 West County Road B

Saint Paul, Minnesota 55113

REGISTERED CIVIL ENGINEER AND LAND SURVEYOR

## Certificate of Survey

I Hereby Certify that this plat shows a survey made by me of the property described on this plat, and that the corners are correctly placed as shown, and that all locations have been correctly shown.

Project No. Minn A-1-1

Parcel No 127-A

Area 4,647. Sq. Ft. m.o.l.

Surveyed For *Housing Authority*

Date *January 1977*

Scale *1" = 40'*

By *Charles O. Georgi*  
REGISTERED LAND SURVEYOR

### Description:

Lot 6,  
Block 2,  
"Selby, McClung and Vanmeter's"  
Addition to Saint Paul, Ramsey County,  
Minnesota.

DAYTON AVE.

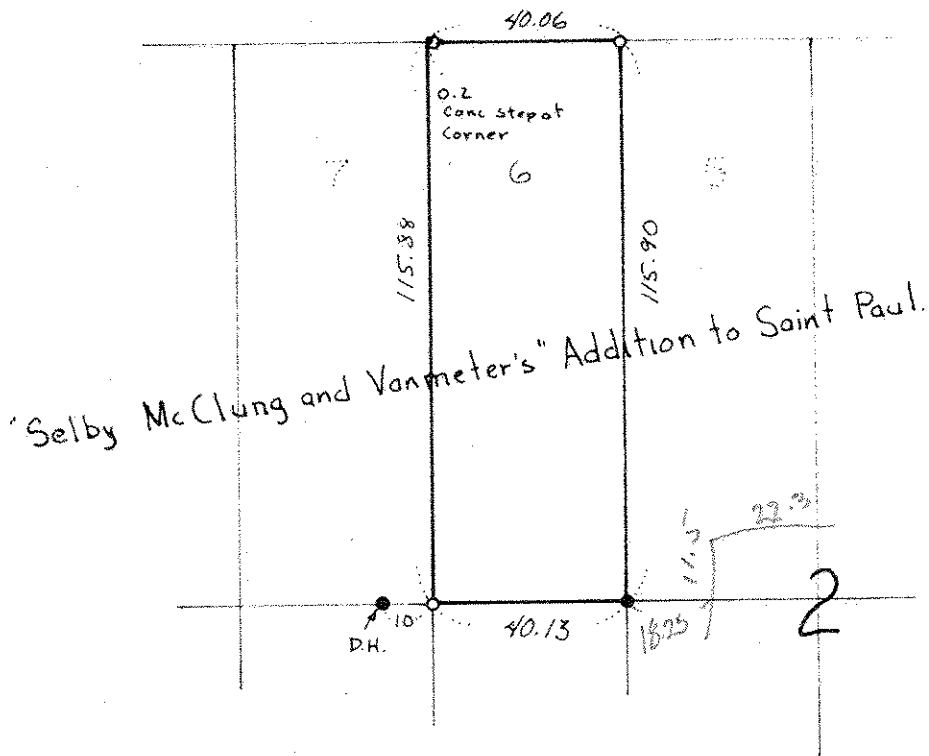

- o denotes iron pipe monument
- denotes iron pipe monument found in place