

CHARLES O. GEORGI COMPANY

2215 West County Road B

Saint Paul 8, Minnesota

MINNESOTA REGISTERED LAND SURVEYOR



I Hereby Certify that this plat shows a survey made by me of the property described on this plat, and that the corners are correctly placed as shown, and that all locations, encroachments, etc., have been correctly shown.

Surveyed For MR. W. A. STEPHENS.....

Date March 1957.....

Scale 1" = 50'.....

By *Charles O. Georgi*
REGISTERED LAND SURVEYOR

DESCRIPTION:

LOT 16
BLOCK 1
SCHREIBER ADDITION PLAT 2

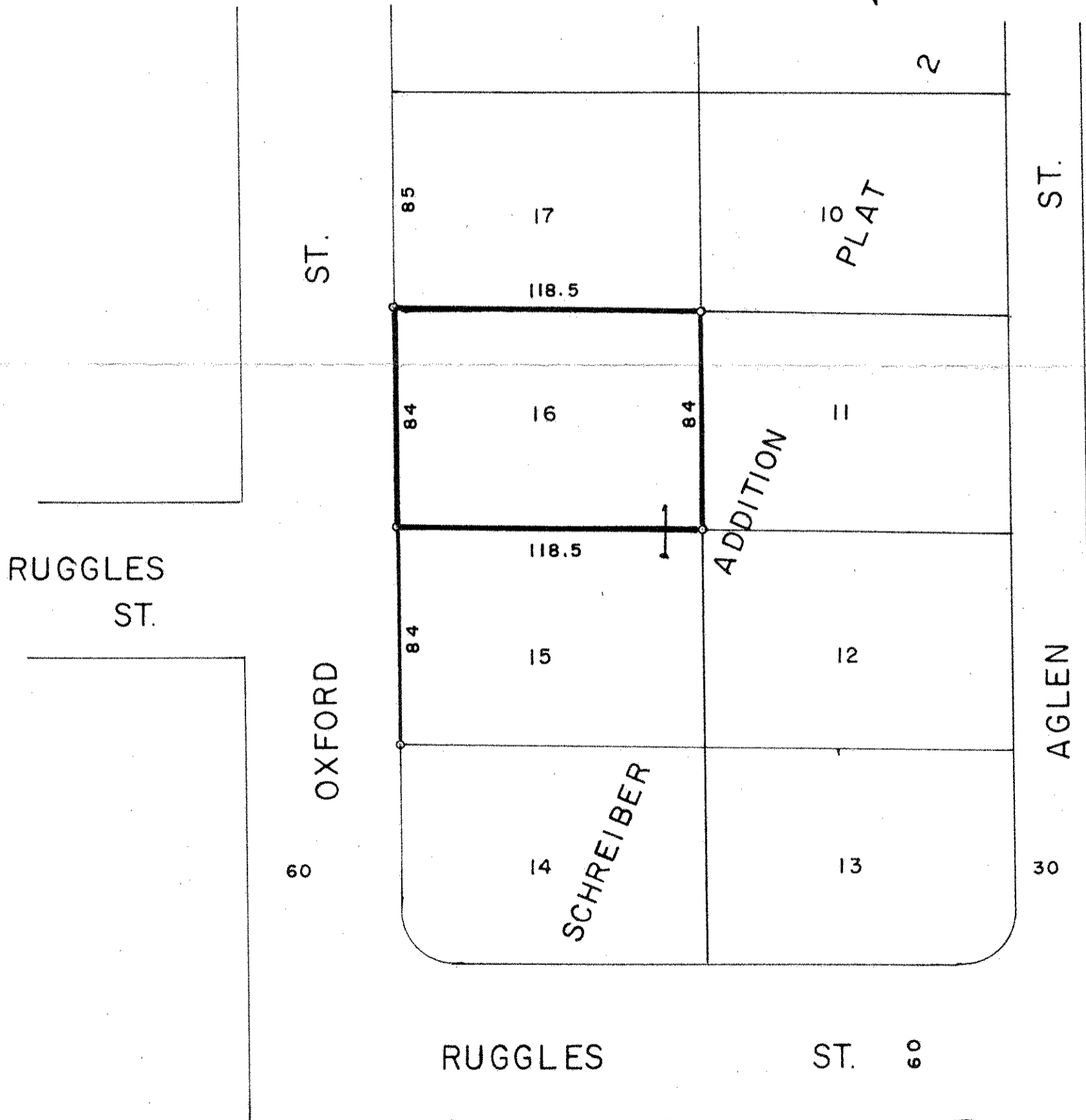

° Denotes Iron Monument