

PLAT OF SURVEY

OF PROPERTY OF Philip W. Heir
 DESCRIBED AS FOLLOWS Lot 3, George H. Schickler's Addition
No 466 Edmund Ave., St. Paul, Minn.

SCALE: 1 INCH = 30 FEET

T. J. WELCH, REGISTERED SURVEYOR
 701 EAST 3RD STREET, ST. PAUL, MINN. 55106

EDMUND AVE.

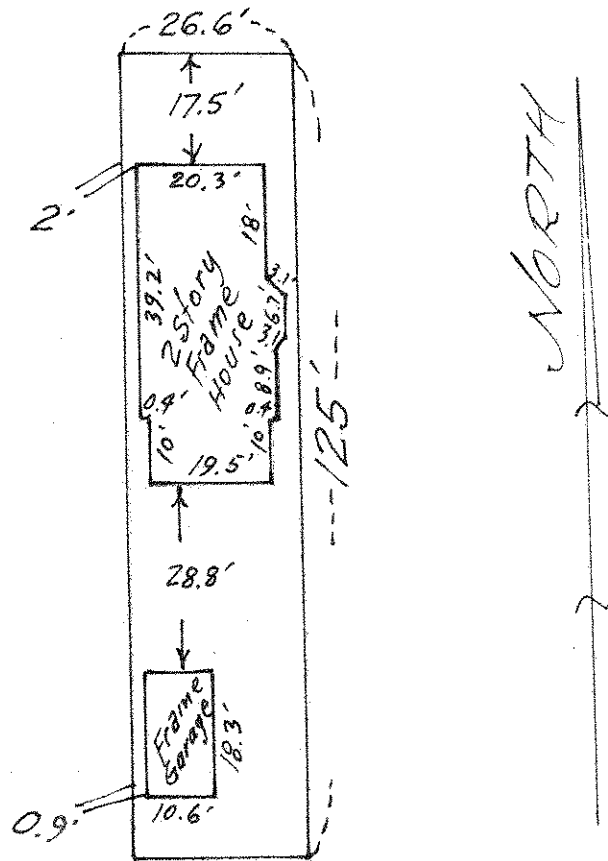

13' ALLEY

CERTIFICATE OF SURVEY

I hereby certify that on Aug. 14 1971
 I surveyed the property described above and that the above
 plat is a correct representation of said survey.

T. J. Welch

*This survey is made exclusively for
 First Federal Savings & Loan Assn. of
 St. Paul. Lot lines are not guaranteed
 as this is survey for mortgage purposes
 only.*