

-24" M.P. Gas line 18' SEly of NWly line of 6th St

Hyd. N.E. Cor. 6th & Jackson  
Top 67.00

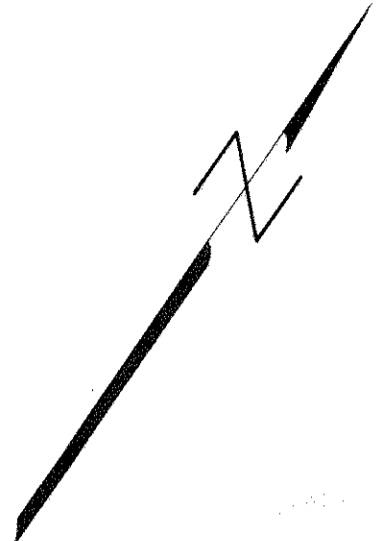
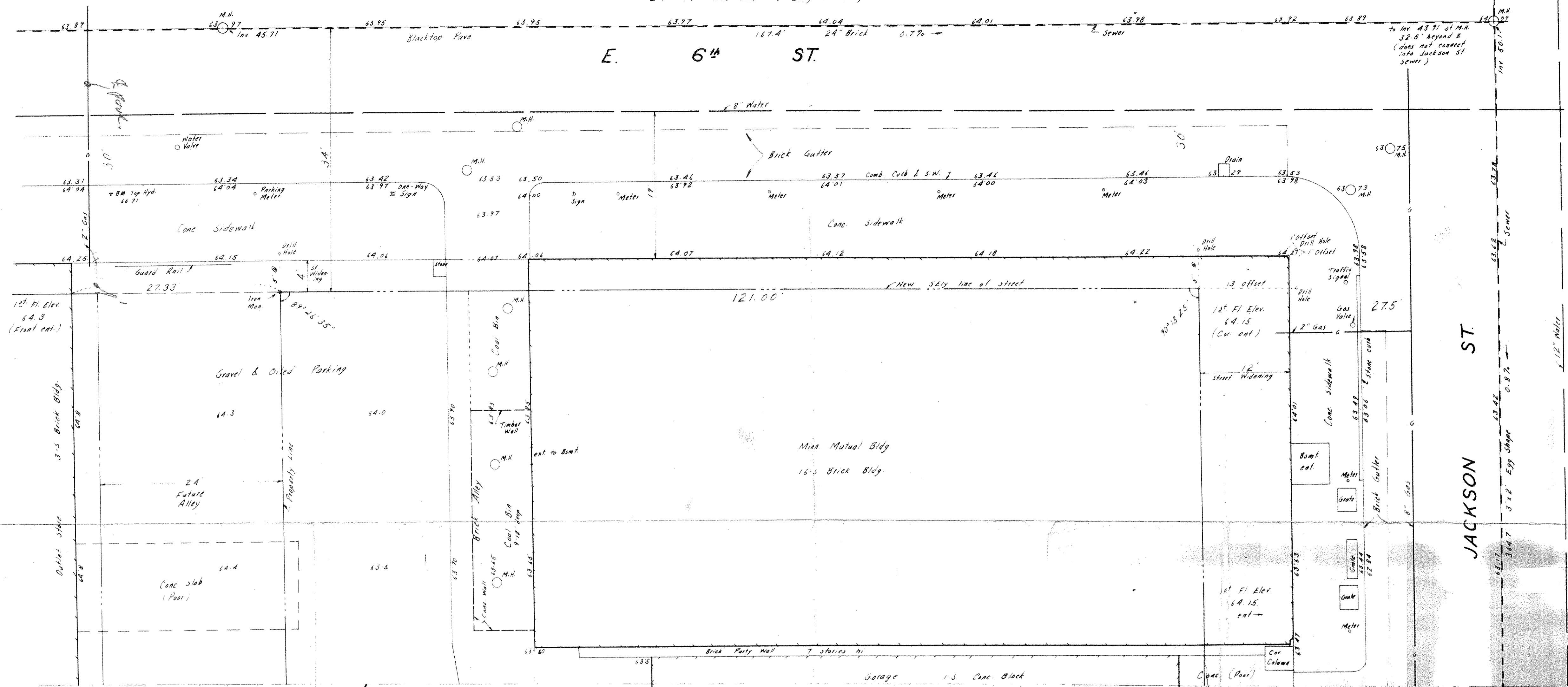

*Northwesterly Part*

**SITE MAP**  
**FARM CREDIT BANKS**  
 ST. PAUL, MINN.

SCALE 1/8" = 1'

Charles O. Georgi Company  
 Civil Engineering & Land Surveying  
 2215 W. Co. Rd. B, St. Paul 13, Minn.  
 Nov. 1964

Sheet 2 of 2