

FROM THE OFFICE OF

CHARLES O. GEORGI COMPANY

2215 West County Road B Saint Paul, Minnesota 55113

REGISTERED CIVIL ENGINEER AND LAND SURVEYOR



I Hereby Certify that this plat shows a survey made by me of the property described on this plat, ^{walkways and escalators} and that the corners are correctly placed as shown, and that all locations have been correctly shown.
With Added modifications and changes.

Surveyed For Housing Authority of Transamerica
Date July 1974
Scale 1" = 20'

By Charles O. Georgi
REGISTERED LAND SURVEYOR

SHEET A

For Descriptions see attached 8 1/2" x 11" Sheets

NEW TRANSAMERICA BUILDING ST. PAUL, MINN

Descriptions:
See Attached Sheets

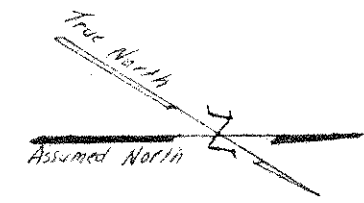

MINNESOTA ST.

