

FROM THE OFFICE OF

# CHARLES O. GEORGI COMPANY

2215 West County Road B

Saint Paul 8, Minnesota

MINNESOTA REGISTERED LAND SURVEYOR



## Certificate of Survey

I Hereby Certify that this plat shows a ~~survey~~<sup>building location</sup> made by me of the property described on this plat, and that the corners are correctly placed as shown, and that all locations, encroachments, etc., have been correctly shown.

W<sup>m</sup> F. Orme - Moore, Costello, & Hart, Attorney

4-15-69 Show Overhang Dimension

Surveyed For New York Life Insurance Company

Date: March 1969

Scale: 1" = 30'

By *Charles O. Georgi*  
REGISTERED LAND SURVEYOR

### Description:

See boundary survey for lengthy description.

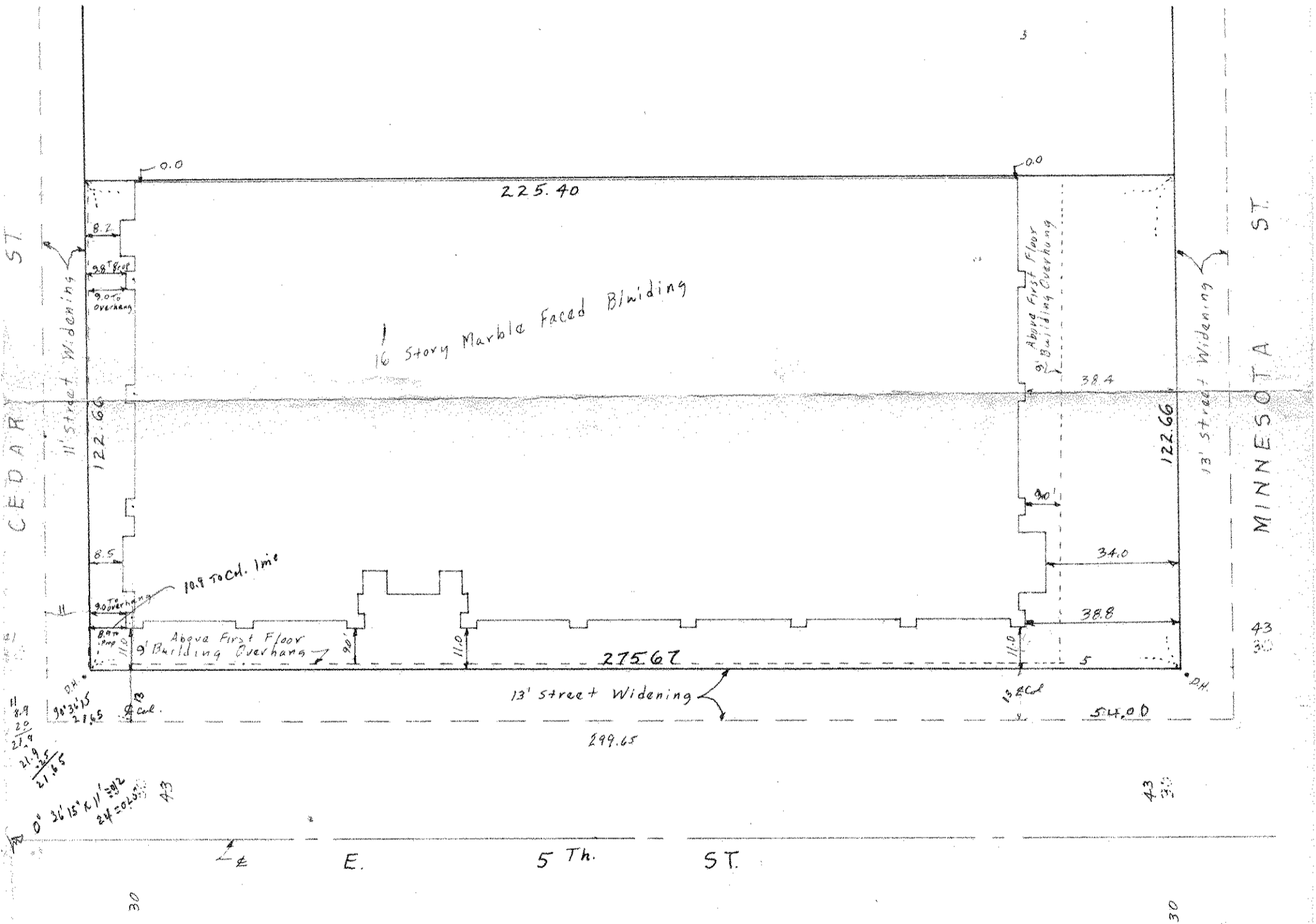

• D.H. Danotas Drill Hole in Concrete on 1 foot offsets from corner.

