

# Certificate of Survey

From the office of  
**GEORGI-SCHMIDT & ASSOC. INC.**

3092 No. Lexington Ave., Roseville, Mn. 55113

LAND SURVEYING

483-4408

I Hereby Certify that this plat shows a survey made by me of the property described on this plat, and that the corners are correctly placed as shown, and that all locations have been correctly shown.

Job Number: 981

Surveyed For Housing Authority

Date July 1981

*Paul W. Schmidt*  
R.L.S. #10459

*July 30, 1981*  
*Bro. Bureau*

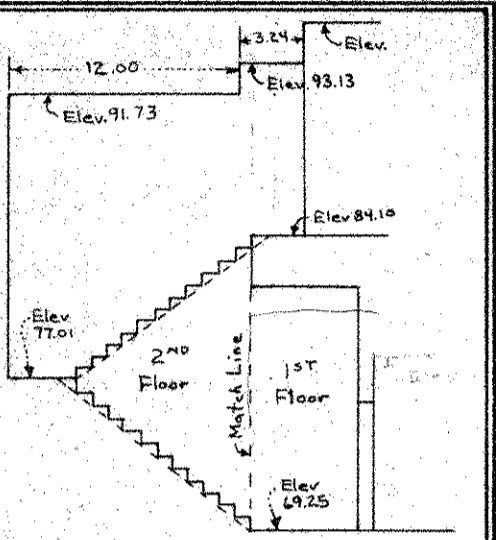

STAIRWAY ELEVATION  
SCALE 1"=10'

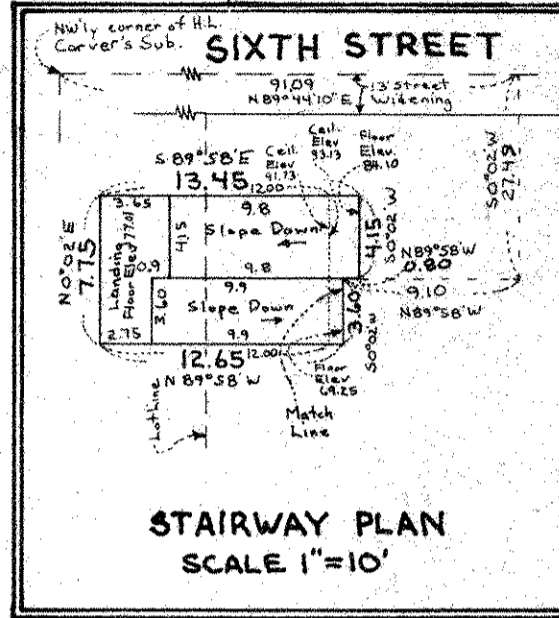

STAIRWAY PLAN  
SCALE 1"=10'

SIXTH STREET

CEDAR STREET

CEDAR STREET

SIXTH STREET

FIRST FLOOR  
SCALE 1"=20'

DETAIL A  
No Scale

DETAIL C  
No Scale

DETAIL B  
No Scale

SECOND FLOOR  
SCALE 1"=20'

H.L. CARVER'S SUBDIVISION

PAUL PROPER BLOCK 10

Lot 5

Lot 6

Lot 7

Lot 8

Lot 9

Lot 10

