

FROM THE OFFICE OF

CHARLES O. GEORGI COMPANY

2215 West County Road B

Saint Paul 8, Minnesota

MINNESOTA REGISTERED LAND SURVEYOR

Certificate of Survey

I Herby Certify that this plat shows a survey made by me of the property described on this plat, and that the corners are correctly placed as shown, and that all locations, encroachments, etc., have been correctly shown.

1/74 Added Lot 3 Block 8 WHITNEY & SMITH'S Add. and revise area
2/77 Revised Cert. by showing Parcel 36-C DWS

File: 262's Data

Surveyed For Housing and Redevelopment Authority

Date December 1971 - January 1974

Scale 1" = 40'

By Charles O. Georgi
REGISTERED LAND SURVEYOR

Project No. Minn. A-1-5
Parcel 36-A
Area: 67,152 Sq. Ft., m.o.l.

DESCRIPTION:
See attached sheet

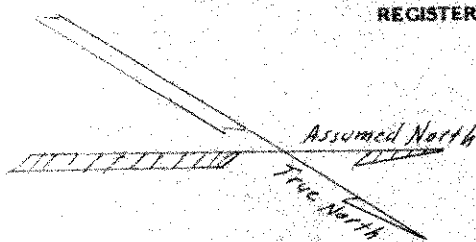

FEB 23 1977

JACKSON ST.

SOUTH
194.62

POINT OF BEGINNING
APPROX
SOUTH
194.62

WHITNEY AND SMITH'S ADDITION

E. SEVENTH ST.

SIBLEY ST.

201.36
N 0° 00' 30" W

