

LOTS 8, 9 & 10 BLOCK 45
ST. ANTHONY PARK NORTH,

JOHN B. IRVINE, SURVEYOR.

416 GLOBE BLDG.

JULY 6.-07.

SCALE 20 ft. per inch.

□ INDICATES STAKE

ALLEY,

ST.

CHILMSFORD

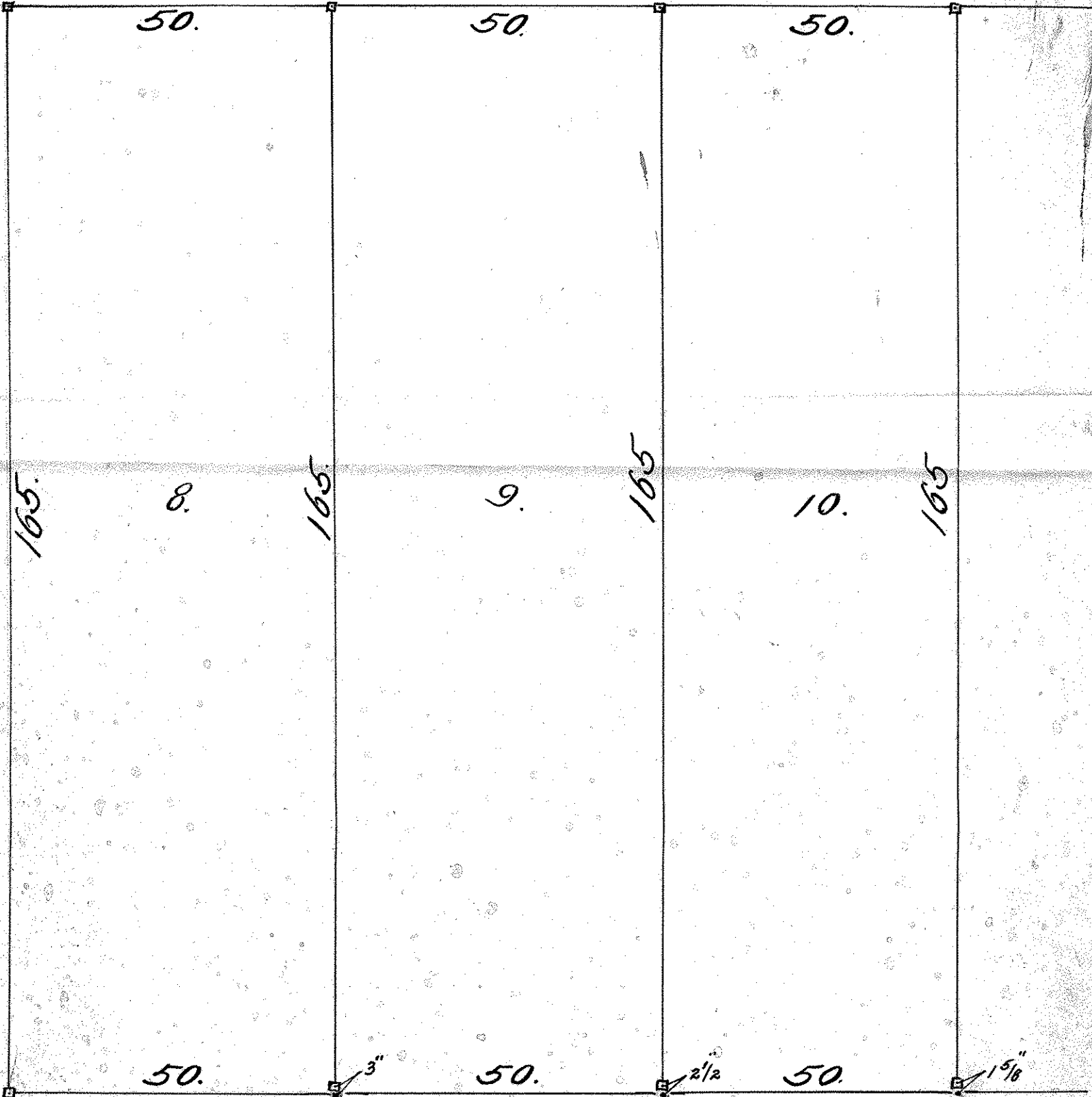

HOLE IN WALK 3" KNAAPP

HOLE IN WALK 2 1/2" ST.

HOLE IN WALK 1 5/8"