

Lean 7116

TELEPHONE TOWER 0640

PLAT OF SURVEY

OF PROPERTY OF Bruce E. Balon
 DESCRIBED AS FOLLOWS Lot 20 Block 31 St. Anthony Park North
N^o 1320 Keston Street, St. Paul, Minn.

SCALE: 1 INCH = 30 FEET

T. J. WELCH, REGISTERED SURVEYOR
 738 SURREY AVENUE, ST. PAUL 6, MINN.

KESTON STREET

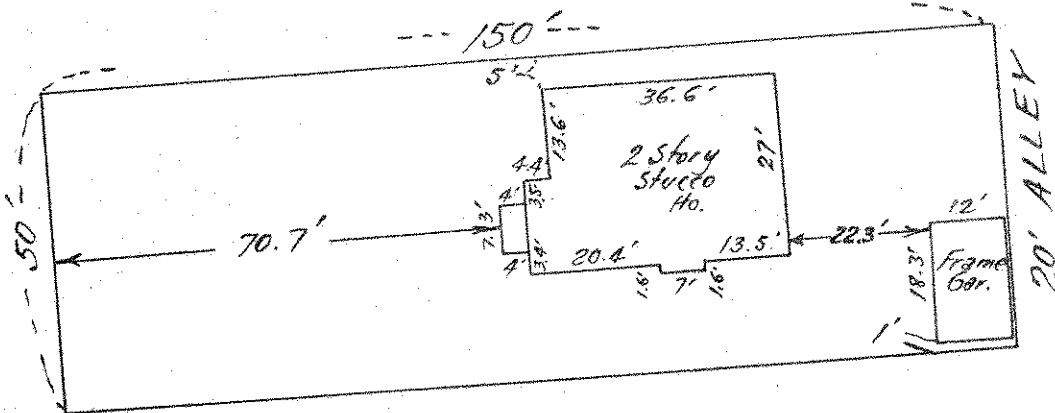

CERTIFICATE OF SURVEY

I hereby certify that on 9-24 1957
 I surveyed the property described above and that the above
 plat is a correct representation of said survey.

T. J. Welch