

PLAT OF SURVEY

OF PROPERTY OF E. E. GRAVES
 DESCRIBED AS FOLLOWS Lot 4, Block 3, St. Anthony Park North
No 1501 Hythe Street, St. Paul, Minnesota.

SCALE: 1 INCH = 40 FEET
 o DENOTES IRON

T. J. WELCH, REGISTERED SURVEYOR
 738 SURREY AVENUE, ST. PAUL 6, MINN.

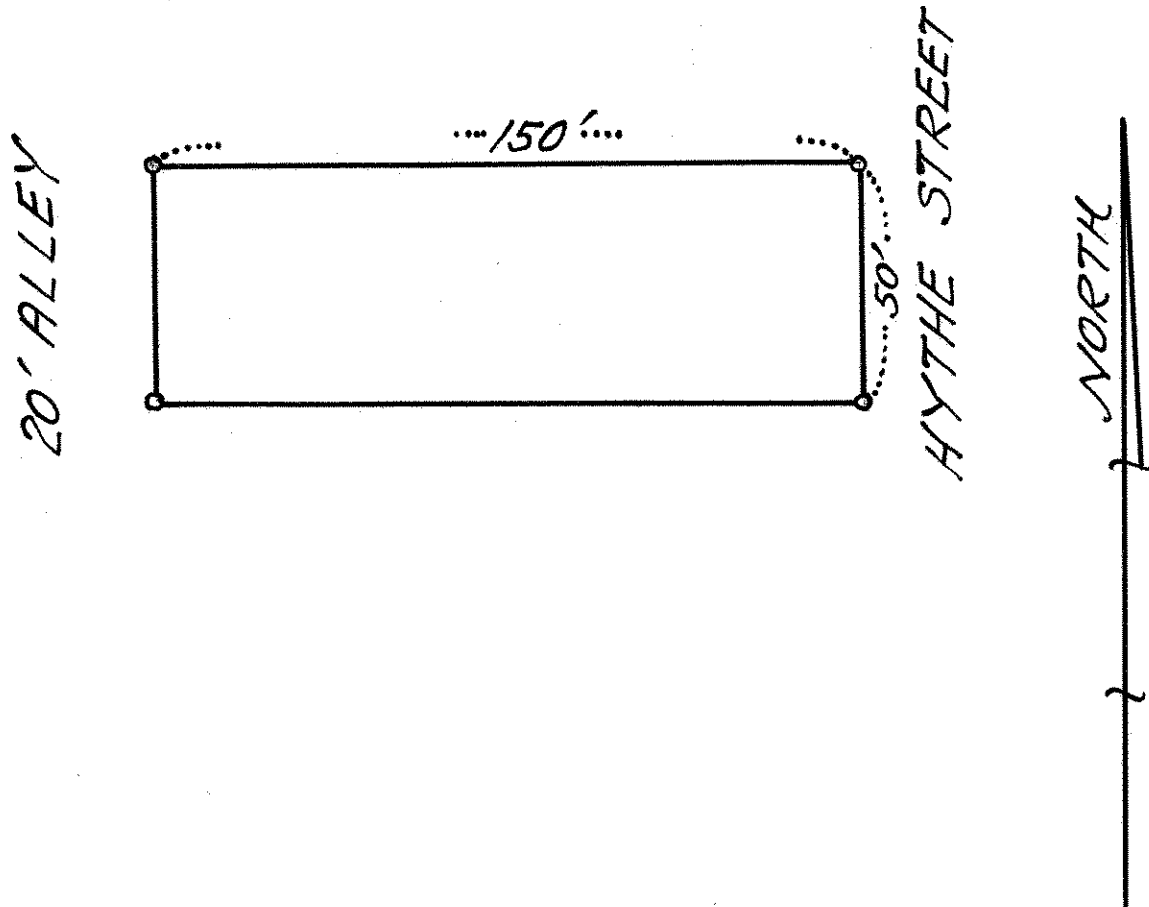

CERTIFICATE OF SURVEY

I hereby certify that on June 14th, 1962
 I surveyed the property described above and that the above
 plat is a correct representation of said survey.

T. J. Welch

285/152
 167