

PLAT OF SURVEY

OF PROPERTY OF *Emil Walsh*

DESCRIBED AS FOLLOWS: *Lot 3, Block 6, St Anthony Park.*

No. 1212 Raymond Ave - St. Paul, Minn.

SCALE: 1 INCH 30 FEET

T. J. WELCH, REGISTERED SURVEYOR
738 SURREY AVENUE, ST. PAUL 6, MINN.

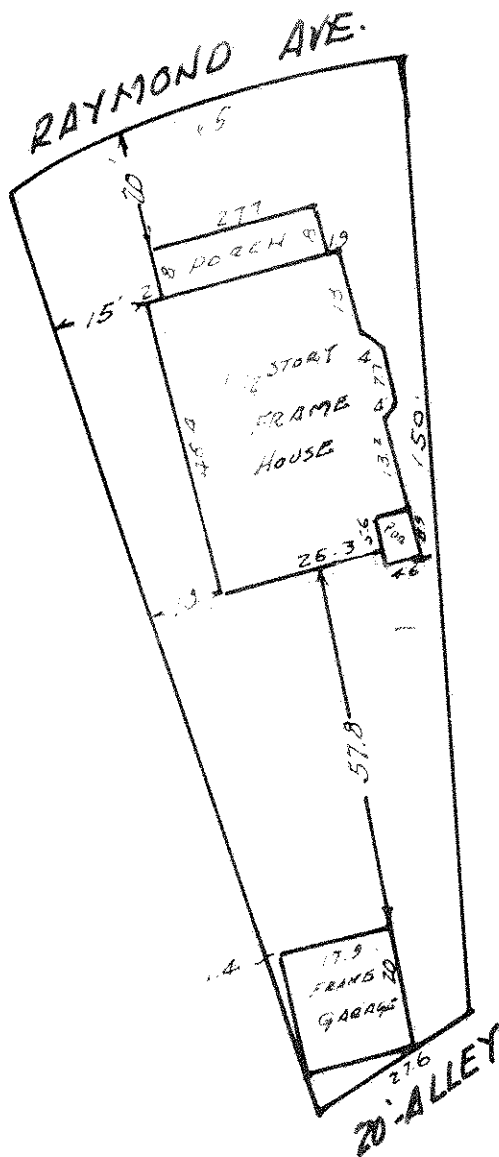

CERTIFICATE OF SURVEY

I hereby certify that on *3-23* 19*54*.
 I surveyed the property described above and that the above
 plat is a correct representation of said survey.

T. J. Welch