

App. 52496

TELEPHONE 776-0640

# PLAT OF SURVEY

OF PROPERTY OF John D. Hoffman and Hyman S. Sigal  
 DESCRIBED AS FOLLOWS Lot 9, Block 7, Boulevard Addition  
No 1447 Hague Ave., St. Paul, Minnesota.

SCALE: 1 INCH = 30 FEET

T. J. WELCH, REGISTERED SURVEYOR  
 701 EAST 3RD STREET, ST. PAUL, MINN. 55106

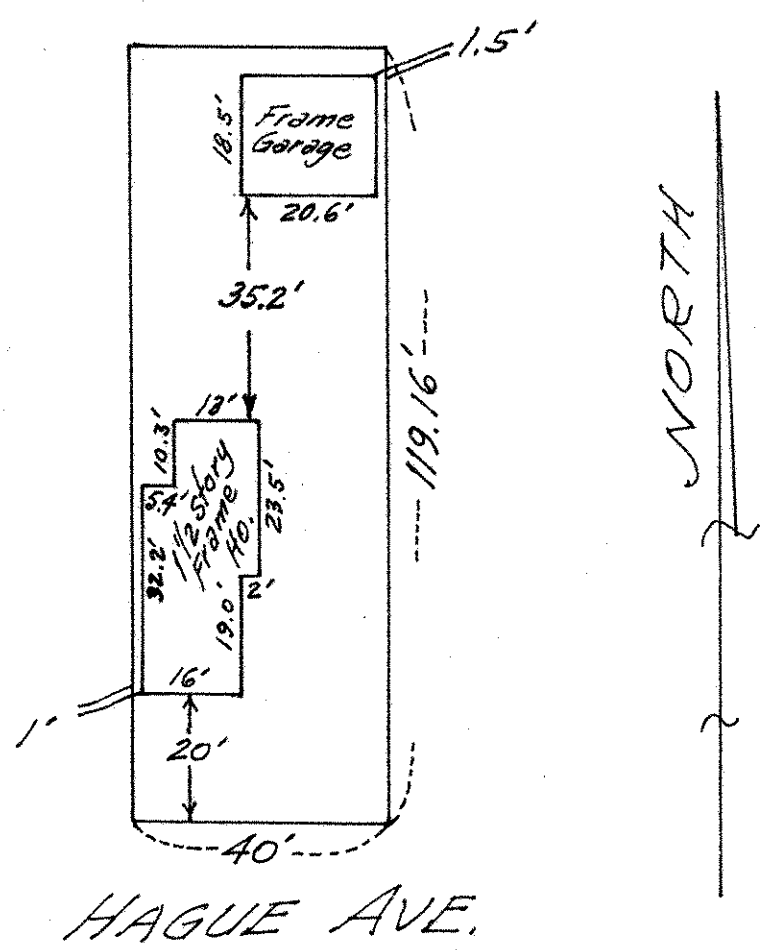

### CERTIFICATE OF SURVEY

I hereby certify that on Feb. 20, 1971  
 I surveyed the property described above and that the above  
 plat is a correct representation of said survey.

T. J. Welch

This Survey is made exclusively for First Federal  
 Savings & Loan Assn. of St. Paul.  
 Lot lines are not guaranteed as this is Survey  
 for mortgage purposes only.

34/80