

FROM THE OFFICE OF

**CHARLES O. GEORGI COMPANY**

2215 West County Road B

Saint Paul, Minnesota 55113

REGISTERED CIVIL ENGINEER AND LAND SURVEYOR

**Certificate  
of Survey**

*I Hereby Certify that this plat shows a survey made by me of the property described on this plat, and that the corners are correctly placed as shown, and that all locations have been correctly shown.*

Surveyed For Merton Christian

Date November, 1970

Scale 1" = 40

By Charles O. Georgi  
REGISTERED LAND SURVEYOR

**Description:**

Lot 6, Block 11,  
Nelson Stevens and King's Addition,  
Ramsey County, Minnesota.

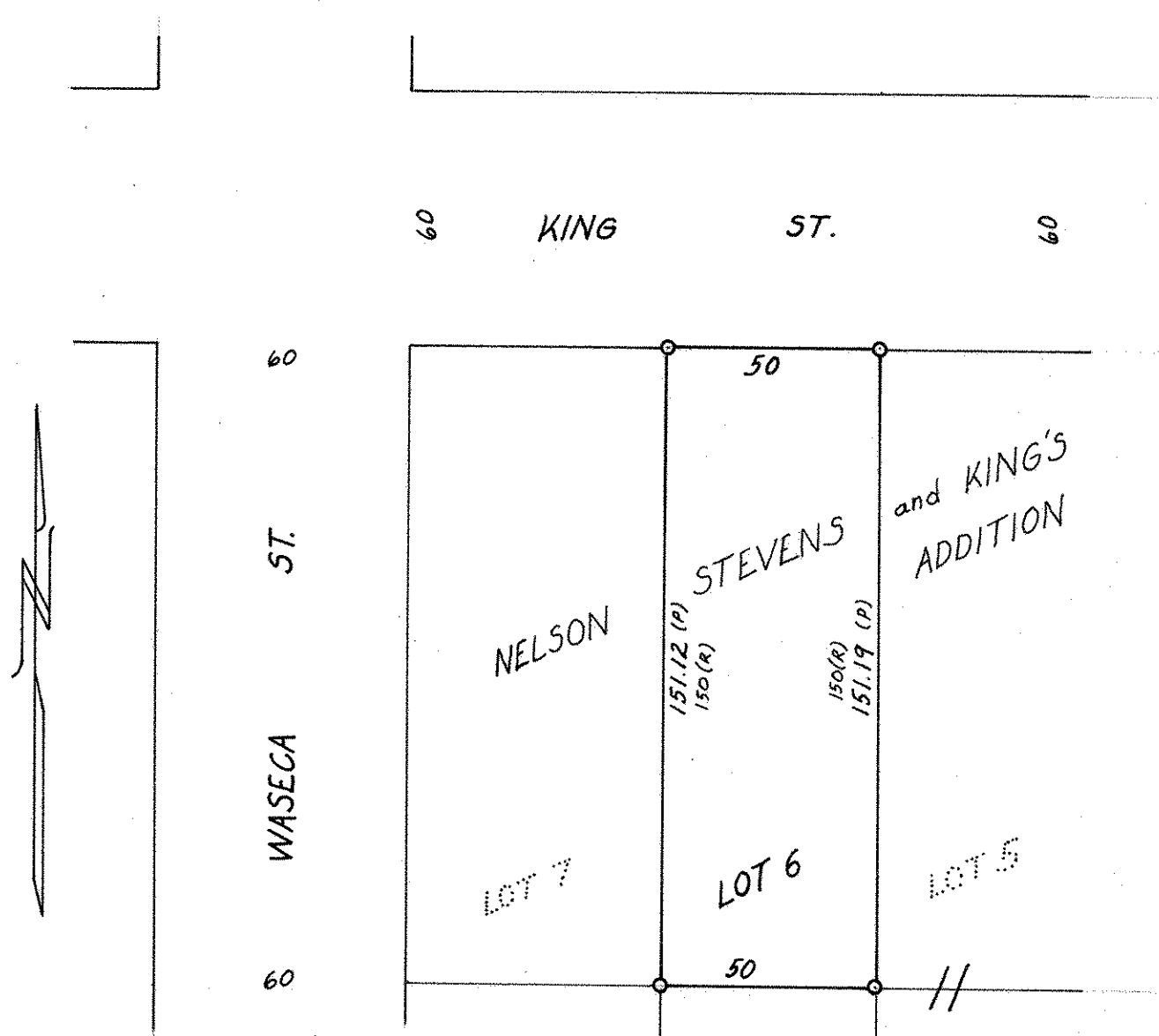

○ Denotes Iron Monument  
(P) Denotes prorated distance  
(R) Denotes record distance