

SE 7, 28, 22

FROM THE OFFICE OF

# CHARLES O. GEORGI COMPANY

2215 West County Road B

Saint Paul 13, Minnesota

REGISTERED CIVIL ENGINEER AND LAND SURVEYOR

## Certificate of Survey

I Hereby Certify that this plat shows a survey made by me of the property described on this plat, and that the corners are correctly placed as shown, and that all locations have been correctly shown.

Surveyed For Mrs Edward Gill

Date August 1965

Scale 1" = 50'

By

*Charles O. Georgi*  
REGISTERED LAND SURVEYOR

### Description:

Lot 2  
Block 22  
Nelson - Stevens and Kings Addition

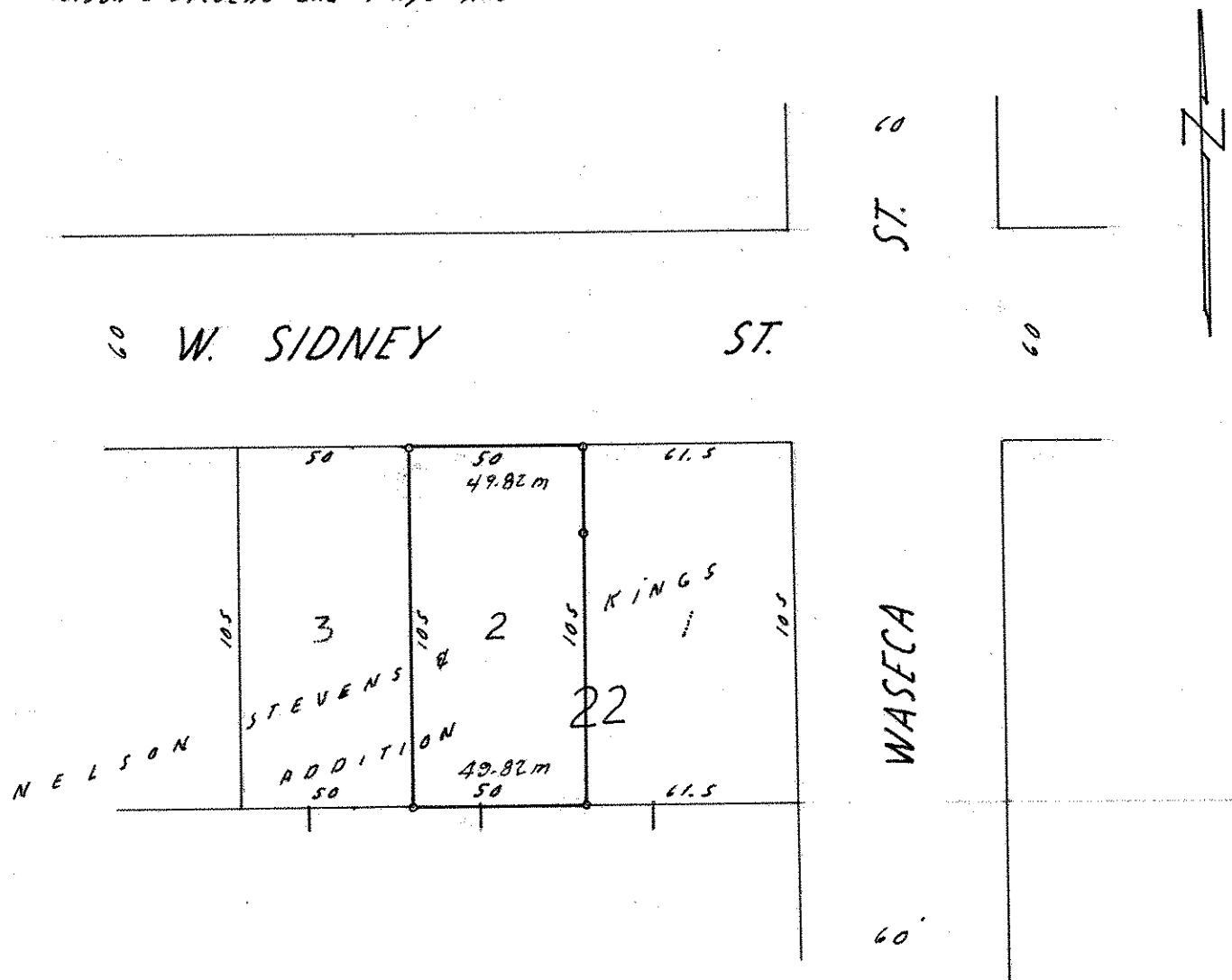

o Denotes Iron Monument  
m - Denotes prorated measurement