

NE 2, 28, 22

FROM THE OFFICE OF

CHARLES O. GEORGI COMPANY

2215 West County Road B

Saint Paul 13, Minnesota

REGISTERED CIVIL ENGINEER AND LAND SURVEYOR

Certificate of Survey

I Hereby Certify that this plat shows a survey made by me of the property described on this plat, and that the corners are correctly placed as shown, and that all locations have been correctly shown.

Surveyed For..... *Richard Henniger*

Date..... *August 1965*

Scale..... *1" = 50'*

By..... *Charles O. Georgi*
REGISTERED LAND SURVEYOR

Description:

Lot 23

Block 1

South Battle Creek Heights

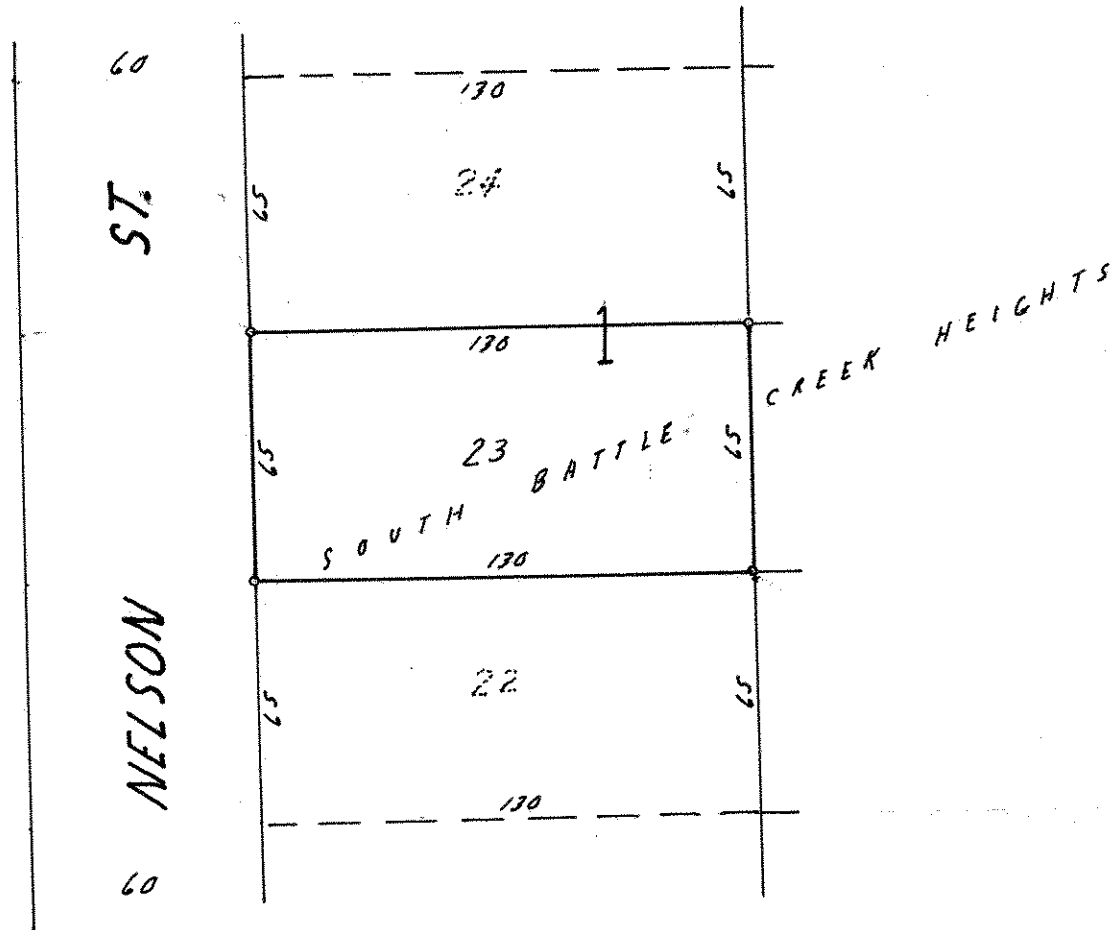

o Denotes Iron Monument