

Certificate of Survey

CHARLES O. GEORGI COMPANY

2215 West County Road B

Saint Paul 13, Minnesota

REGISTERED CIVIL ENGINEER AND LAND SURVEYOR

I Hereby Certify that this plat shows a survey made by me of the property described on this plat, and that the corners are correctly placed as shown, and that all locations have been correctly shown.

Surveyed For *H. A. Halger*

Date *July 1964*

Scale *1" = 50'*

By *Charles O. Georgi*
REGISTERED LAND SURVEYOR

Description:

*Lot 11, and Lot 12, except the South 10 feet thereof
Block 4, Rosehill Addition*

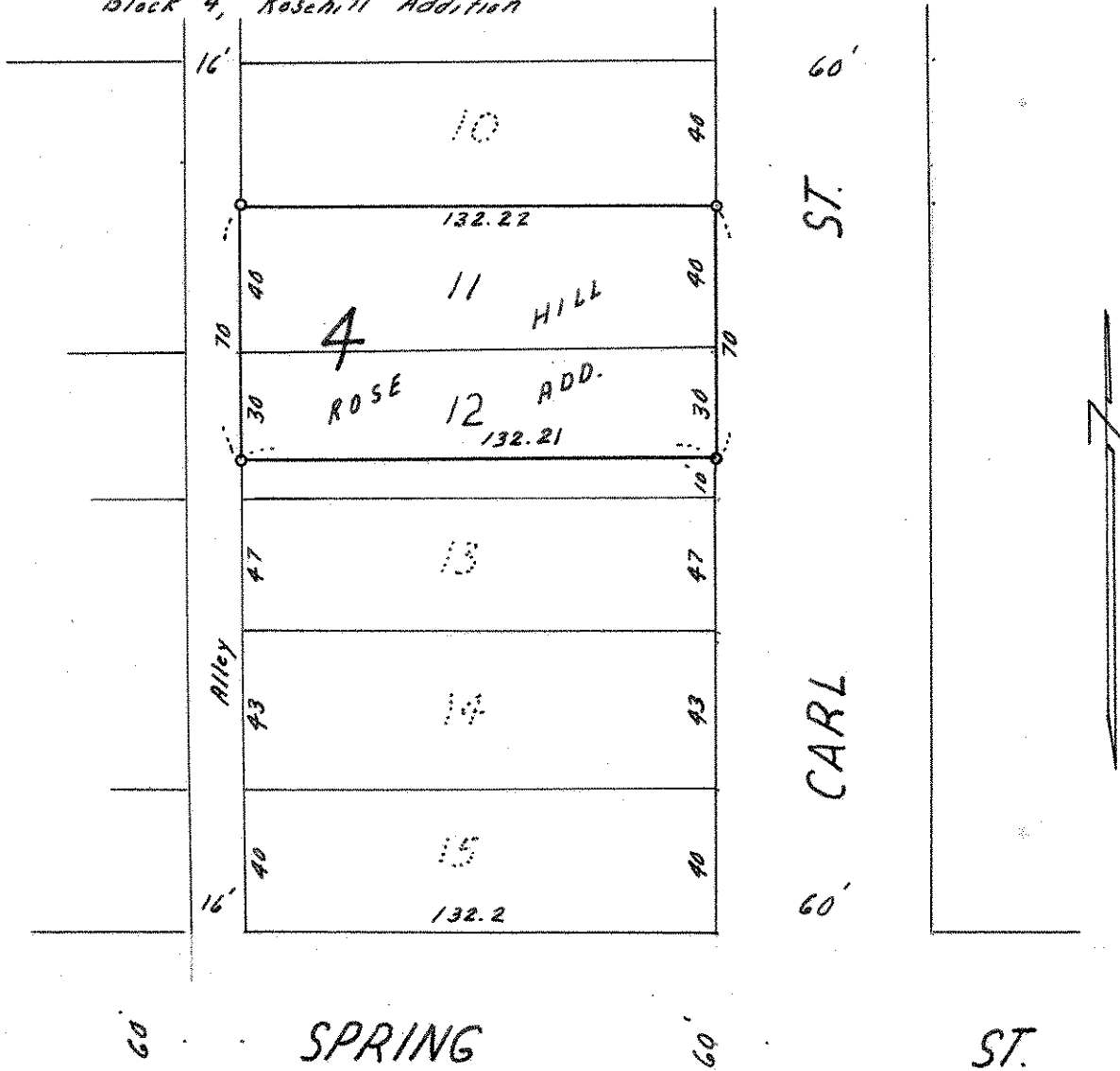

o Denotes Iron Monument