

699-0484

Phone: ~~Minneapolis 9-1232~~

(Evenings Collect)

P. E. HIGHUM

Registered Professional Engineer and Land Surveyor

1275 St. Paul Avenue

St. Paul 16, Minnesota

PLAT OF SURVEY

OF PROPERTY OF MAILAND CONSTRUCTION COMPANY
 described as follows: ALL OF LOTS 13, 14, 15 AND WEST 9 FT. LOT 16
BLOCK 3 BORUP AND PAYNES ADDITION
ST. PAUL- RAMSEY COUNTY- MINNESOTA



Scale: 1 inch.....50.....feet.

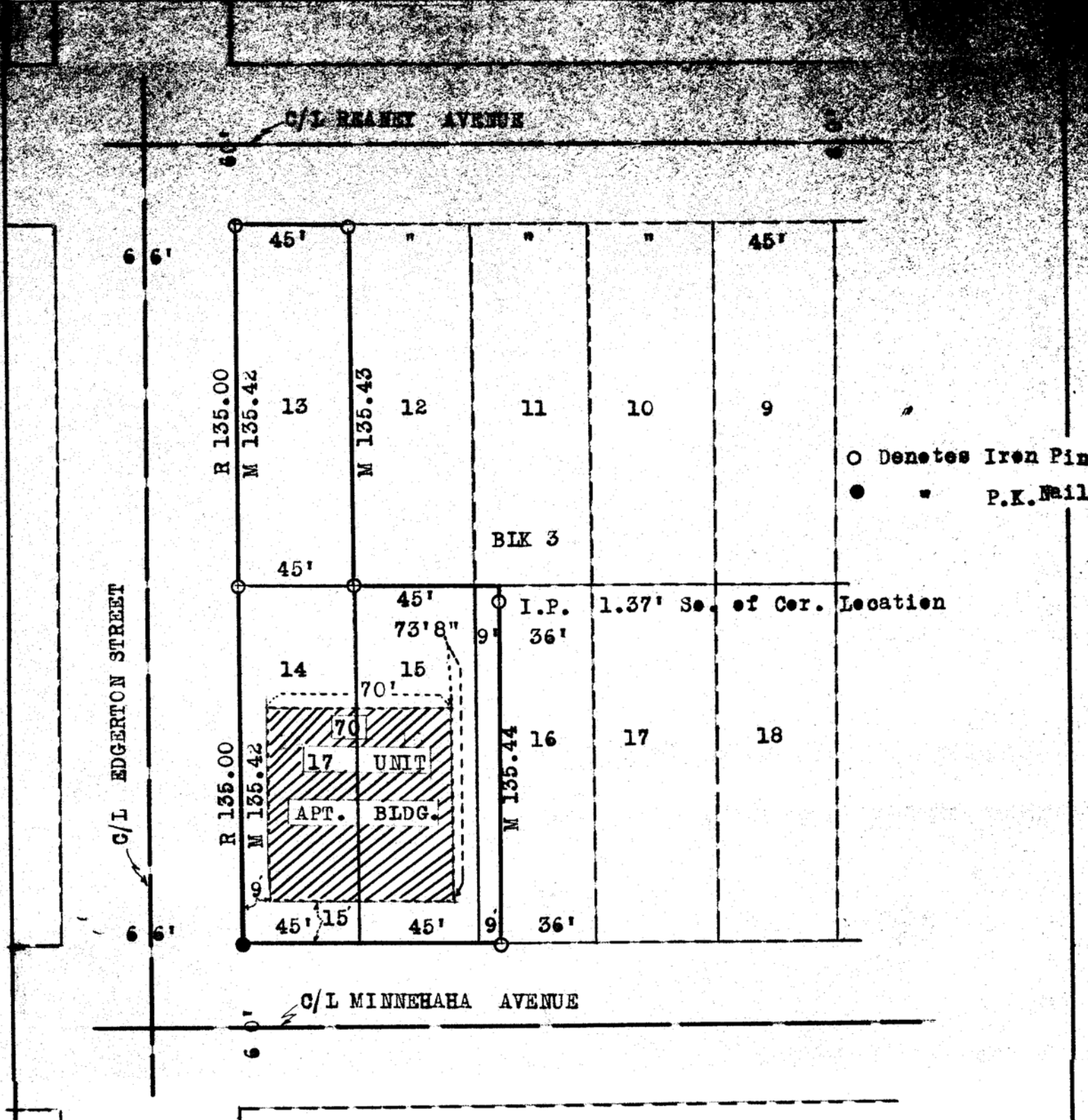

CERTIFICATE OF LOCATION OF BUILDING

I hereby certify that on...JAN. 15...19...64 I made a survey of the proposed location of the building on the above described property and that the location of said building is correctly shown on the above plat.

P. E. Highum
 Minn. Reg. #1538

CERTIFICATE OF SURVEY

I hereby certify that on...JAN. 15...19...64 I surveyed the property described above and that the above plat is a correct representation of said survey.

P. E. Highum
 Minn. Reg. #1538