

Appl. No 30874

TELEPHONE PR 6-0640

# PLAT OF SURVEY

OF PROPERTY OF Richard D. Thomas

DESCRIBED AS FOLLOWS Lot 9 and the West half of Lot 8, except the Easterly 5 feet thereof, Block 13, Boulevard Addition  
No 1432 Portland Ave, St. Paul, Minn.

SCALE: 1 INCH = 30 FEET PORTLAND AVE. T. J. WELCH, REGISTERED SURVEYOR  
738 SURREY AVENUE, ST. PAUL 6, MINN.

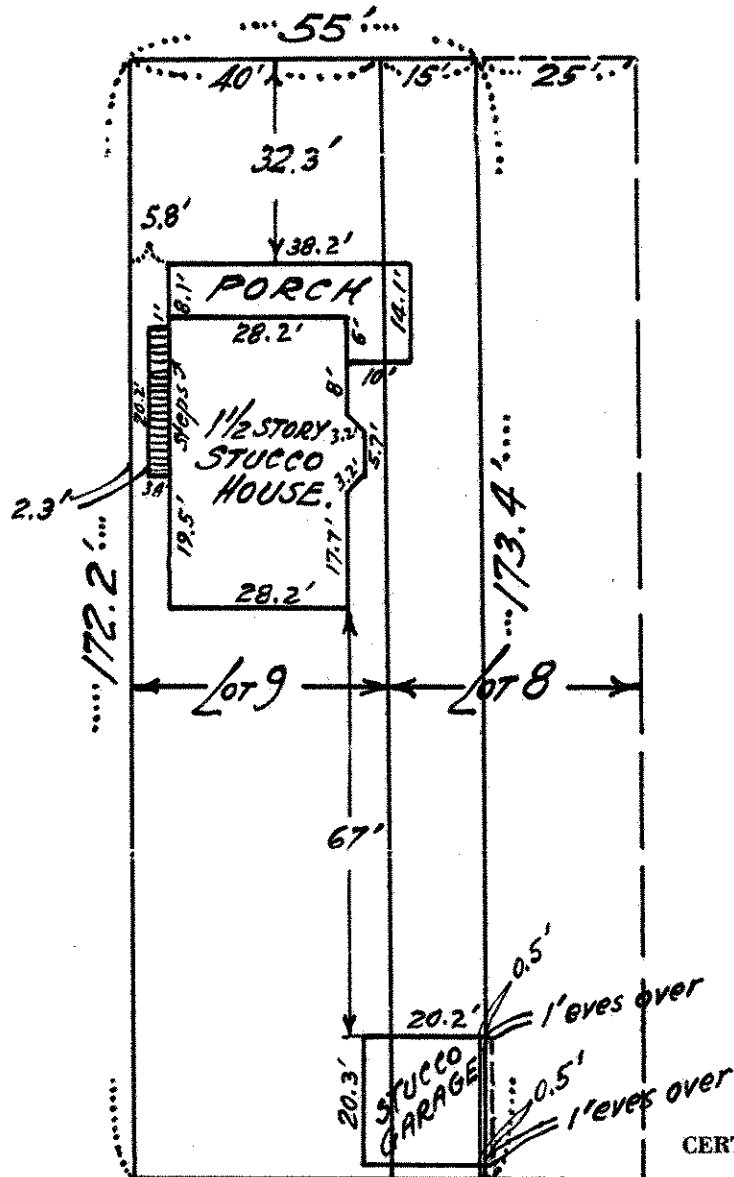

NORTH

## CERTIFICATE OF SURVEY

I hereby certify that on 3-11, 1960

I surveyed the property described above and that the above plat is a correct representation of said survey.

T. J. Welch

20' ALLEY