

NE 29 29 22

FROM THE OFFICE OF

CHARLES O. GEORGI COMPANY

2215 West County Road B

Saint Paul 13, Minnesota

REGISTERED CIVIL ENGINEER AND LAND SURVEYOR

Certificate of Survey

I Hereby Certify that this plat shows a survey made by me of the property described on this plat, and that the corners are correctly placed as shown, and that all locations have been correctly shown.

Surveyed For *Checkerboard Eat Shop, Inc.*
Mr. Atkins

Date *June 1959*

Scale *1" = 30'*

By *Charles O. Georgi*
REGISTERED LAND SURVEYOR

Description:

Lot 1
Block 4
Joseph R. Weides Addition
to City of St. Paul

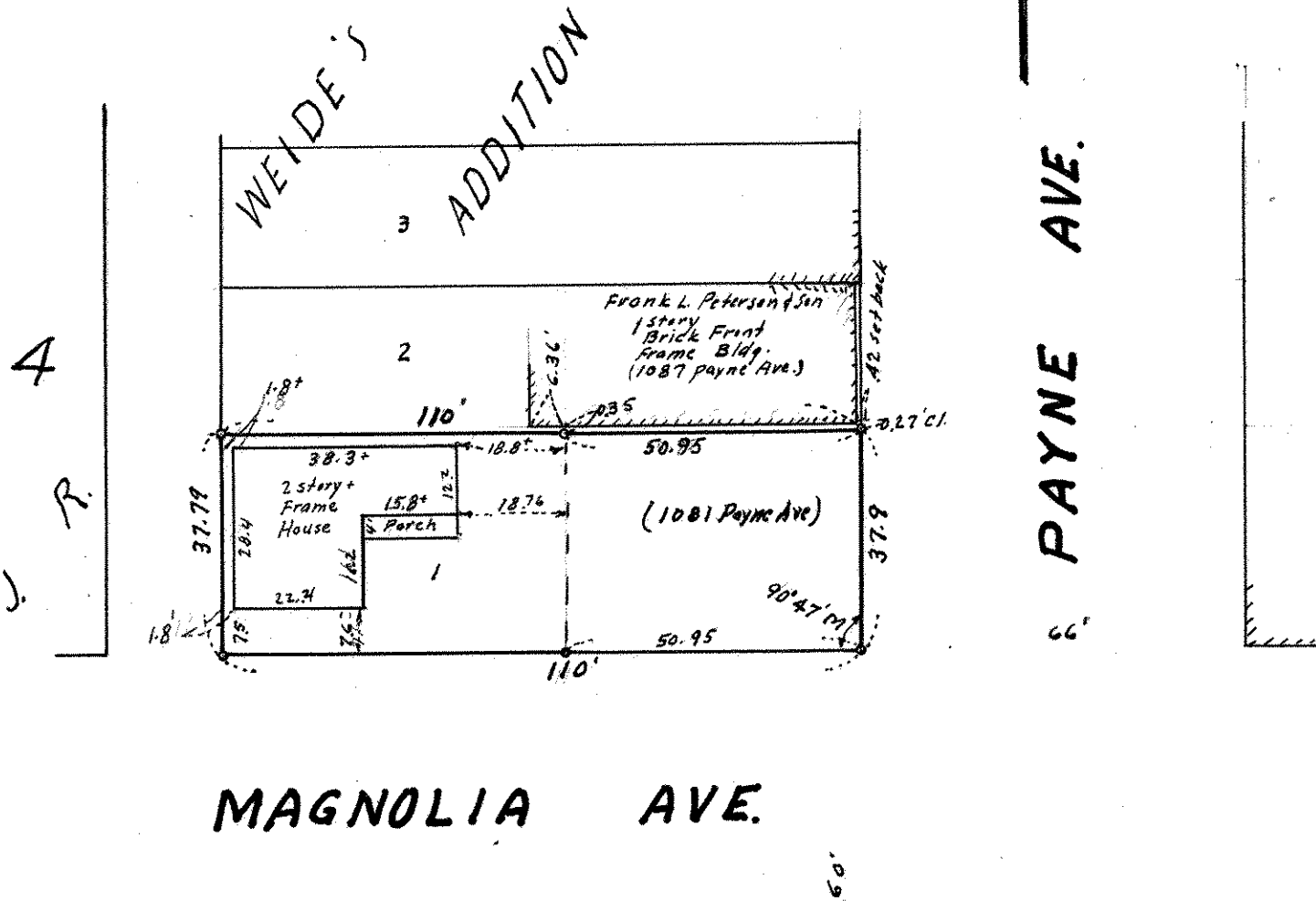

• Denotes Iron Monument
M - Denotes Measured angle or distance

Brick Bldg.

32.92 M □ Stone Mon.