

Appl. 26155

TELEPHONE TOWER 0640

PLAT OF SURVEY

OF PROPERTY OF R. L. Lotten Associates

DESCRIBED AS FOLLOWS Lots 3 and 6 Block 16 Boulevard Addition

No. 1376 Laurel Ave., St. Paul, Minn.

SCALE: 1 INCH = 40 FEET

T. J. WELCH, REGISTERED SURVEYOR
738 SURREY AVENUE, ST. PAUL 6, MINN.

LAUREL AVE.

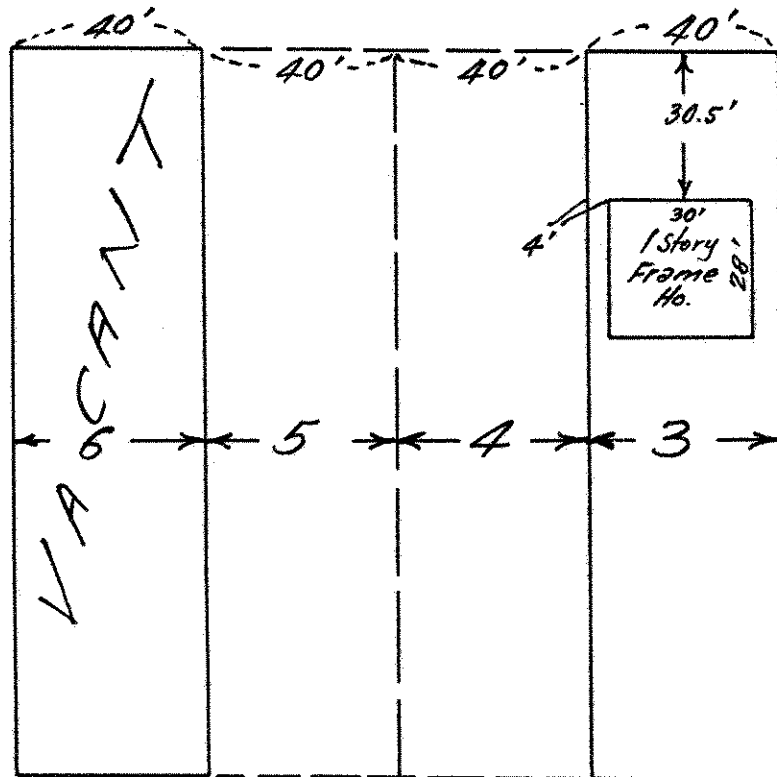

20' ALLEY

CERTIFICATE OF SURVEY

I hereby certify that on 10-19 1957

I surveyed the property described above and that the above plat is a correct representation of said survey.

T. J. Welch