

Appl. 25829

TELEPHONE TOWER 0640

# PLAT OF SURVEY

OF PROPERTY OF William J. Lynch

DESCRIBED AS FOLLOWS The East 1/2 of Lot 21 and the West 1/2 of Lot 22 Block 11 of Boulevard Addition

No 1435 Ashland Ave, St. Paul, Minn.

SCALE: 1 INCH = 30 FEET

T. J. WELCH, REGISTERED SURVEYOR  
738 SURREY AVENUE, ST. PAUL 6, MINN.

20' ALLEY

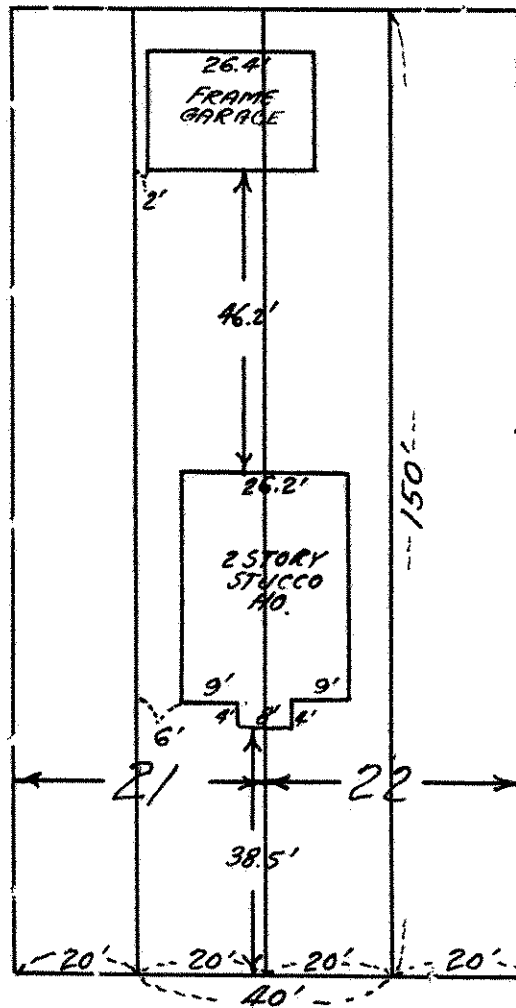

ASHLAND AVE.

CERTIFICATE OF SURVEY

I hereby certify that on 11-8 19 56

I surveyed the property described above and that the above plat is a correct representation of said survey.

T. J. Welch