

Appl. No. 18896

TELEPHONE TOWER 0640

PLAT OF SURVEY

OF PROPERTY OF Arthur L. Seba

DESCRIBED AS FOLLOWS All of Lot 3 except the Westerly 102 feet thereof, and the Westerly 63.5 feet of Lot 2, Block 61, Brown & Jackson's Addition to St. Paul.

No. 319 E. Wyoming St. - St. Paul, Minn.

SCALE: 1 INCH = 50 FEET

T. J. WELCH, REGISTERED SURVEYOR
738 SURREY AVENUE, ST. PAUL 6, MINN.

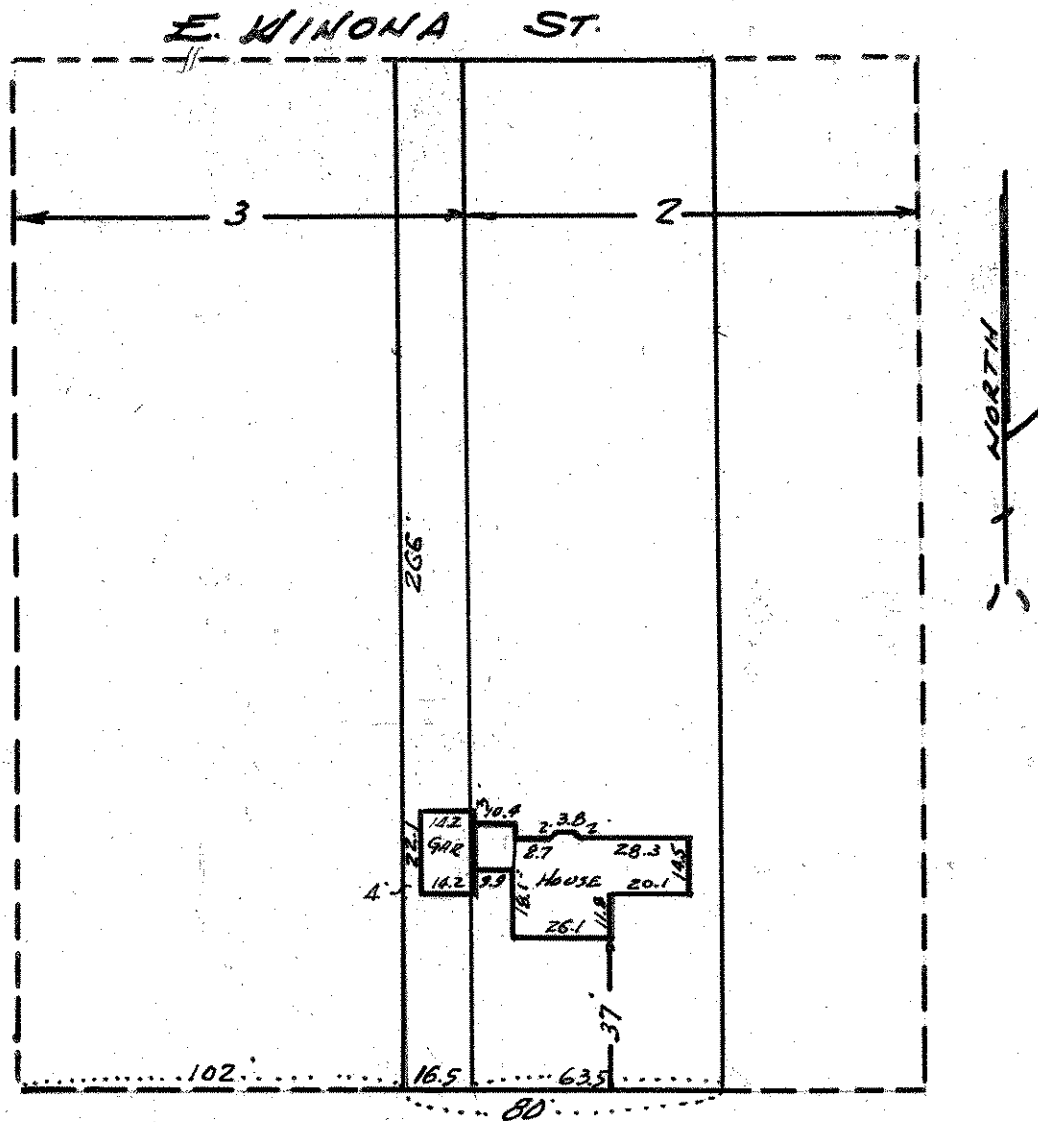

E. WYOMING ST.

CERTIFICATE OF SURVEY

I hereby certify that on 2-1 1954

I surveyed the property described above and that the above plat is a correct representation of said survey.

T. J. Welch