

1400  
MARSHALL

AVE.

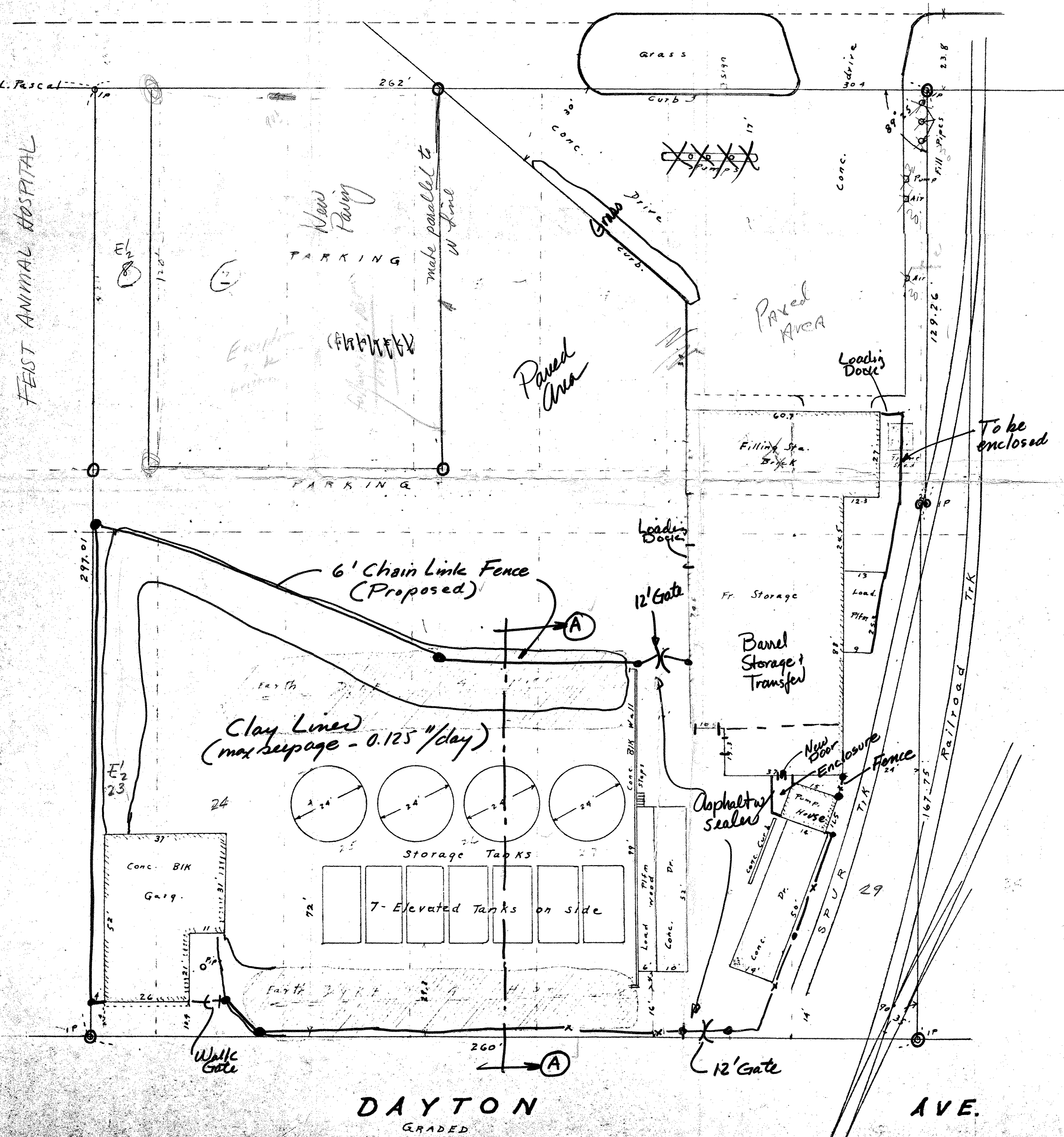

T.M.K.  
SITE MAP  
JENNEX C. ...  
ST. PAUL, MINN.

Dennis Carrin  
Melwyn Bell  
445-1086  
800-643-5810 Arkansas

Survey of West 2ft. of Lot 1 and all of  
Lots 2 thru 7 and East 1/2 of Lots 8 and  
23, and all of Lots 24 thru 29 together  
with vacated alley in B.I.K. 1, Boulevard  
Add. to St. Paul, Ramsey Co. Minn.  
~~and showing plant layout for~~  
~~M. & C. Cantine & Petroleum Corp. of~~  
~~Tulsa OKLA.~~  
Scale 1" = 20ft. Aug. 10 1953  
This Plat is a correct delineation  
of this Survey

Edgar C. Swenson  
Minn. Reg. C.E. & Surveyor  
No. 567

Scale OK Sheet size - 22" x 34"

Billings [ PO Box 238,  
Shakopee, Minn. 55379  
Chemex Property  
defined by circles  
(Require revised site plan,  
critical elevations for  
drainage, utilities, etc.  
Engineers to show proposed  
improvements, section w/  
elevations through diked  
area, existing piping  
diagram (schematic) pumps,  
electrical river diagram)

PLAN SHEET

Total  
77,814  
12,500  
64,714