

# PLAT OF SURVEY

OF Warren - Dodge  
FOLLOWS Lot 14, Blk 18, Auditors Subdivision No 11

13 Portland Ave. - St. Paul, Minn.

INCH 30 FEET.

T. J. WELCH, REGISTERED SURVEYOR  
738 VAN BUREN PLACE, ST. PAUL, MINN.

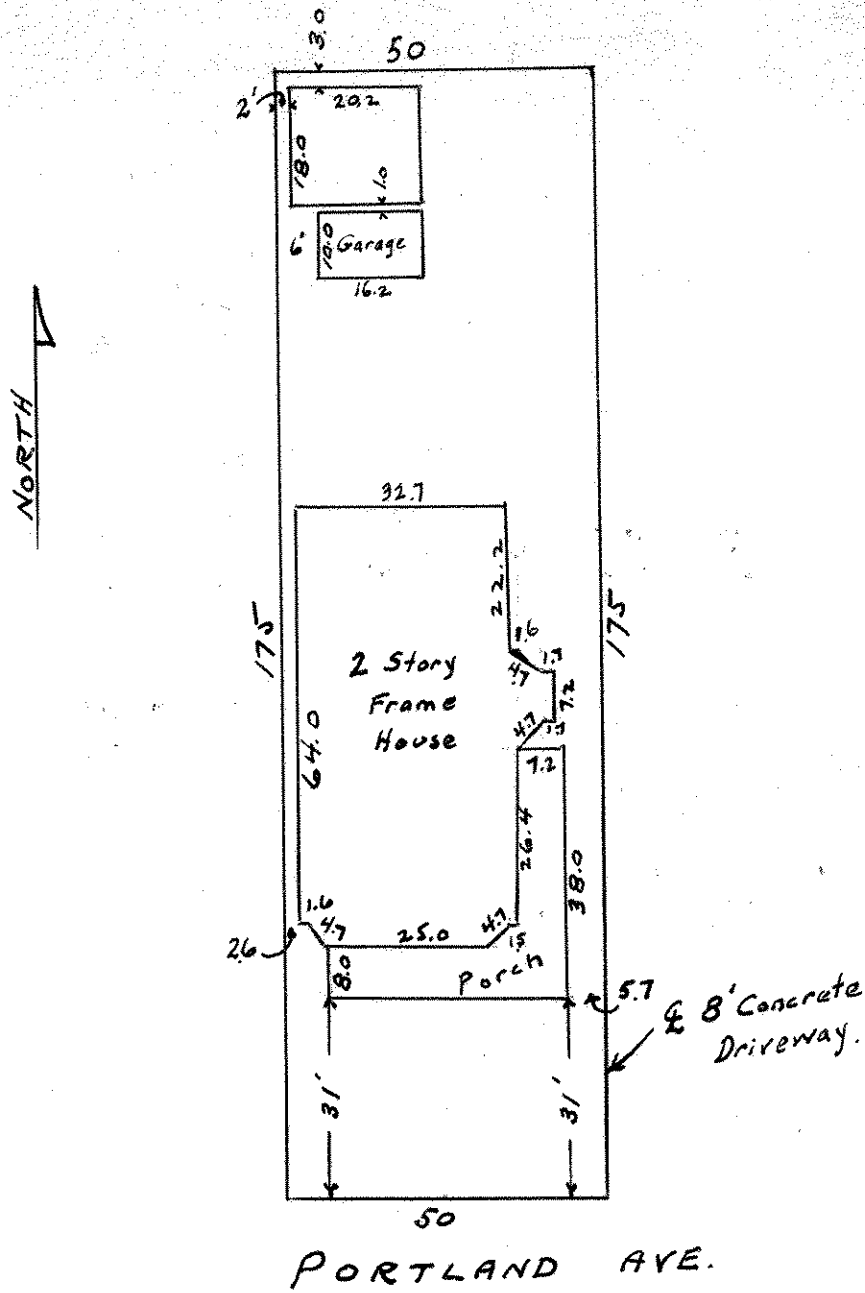

## CERTIFICATE OF LOCATION OF BUILDING

I hereby certify that on Apr 4, 1939  
I made a survey of the location of the building on the above  
described property and that the location of said building is  
correctly shown on the above plat.

T. J. Welch

## CERTIFICATE OF SURVEY

I hereby certify that on Apr 4, 1939  
I surveyed the property described above and that the above  
plat is a correct representation of said survey.

T. J. Welch