

PLAT OF SURVEY

OF PROPERTY OF Melvin Hiner. RIVER
DESCRIBED AS FOLLOWS Lot 13, Block, 6, Boulevard Addition.

SCALE: 1 INCH 20 FEET.
O - Indicates Iron.

T. J. WELCH, REGISTERED SURVEYOR
738 VAN BUREN PLACE, ST. PAUL, MINN.

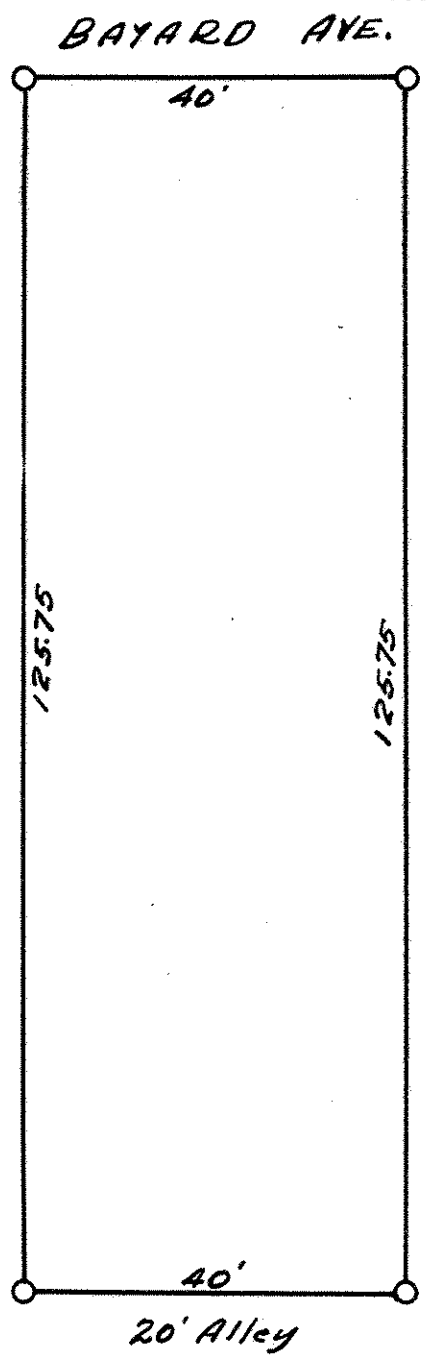

CERTIFICATE OF LOCATION OF BUILDING

I hereby certify that on _____ 19____
I made a survey of the location of the building on the above
described property and that the location of said building is
correctly shown on the above plat.

CERTIFICATE OF SURVEY

I hereby certify that on June 13, 1939
I surveyed the property described above and that the above
plat is a correct representation of said survey.

T. J. Welch