

B. 56

SW 28 22

JOHN B. IRVINE,
COUNTY SURVEYOR

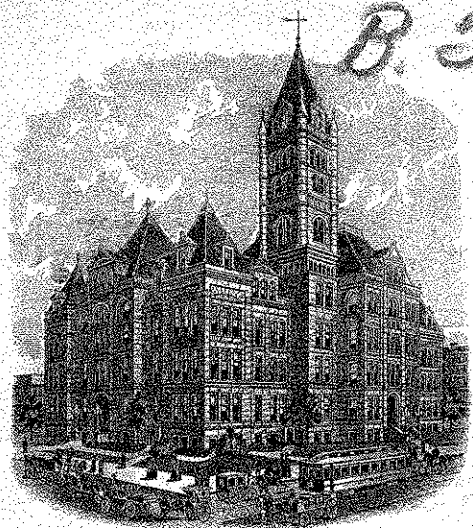

RAMSEY COUNTY COURT HOUSE

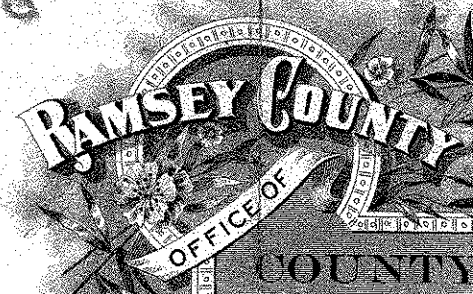

408 GLOBE BLDG.,
4TH & CEDAR STS.

St. Paul, Minn.

*Lot 5 Blk 56
Lawton Bros add.
B+O
J. E. O. Ingalls
Nov. - 13 - 1909.*

Delaware

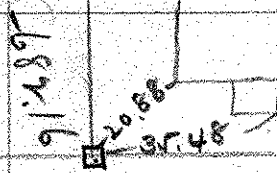

1042.75
144.35

Ottawa 300.35

140.8 foundation 140.18
100.18

38.3 37.5 37.5 37.5

Minnesota
141.6
144.35

9
141.6

10
141.6

11
141.6

12

141.90



5
141.78

150.16

144.35
141.78

Delaware
304.70
144.35

80
804.70
144.35

8
141.6

7
141.68

6
141.96

5
141.83

1
141.90

2

3

4
141.78

37.83
37.9

37.43
37.5

37.5
37.5

37.43
37.5

37.53
37.53

37.53
37.53

37.53
37.53

37.53
37.53

37.53
37.53

150.4
150.12

300.23
150.12

Smith

60

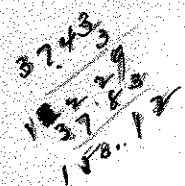

Res. Line

747

Minnesota add.
1017