

Map showing the Definite Location of the
Lake Superior & Mississippi Railroad
through

PH 44

Portions of Sections 32-29 & 28. T29. R 22. in Ramsey County.
Minnesota.

Scale - 60 ft. to 1 inch -
N.B. All measurements in feet.

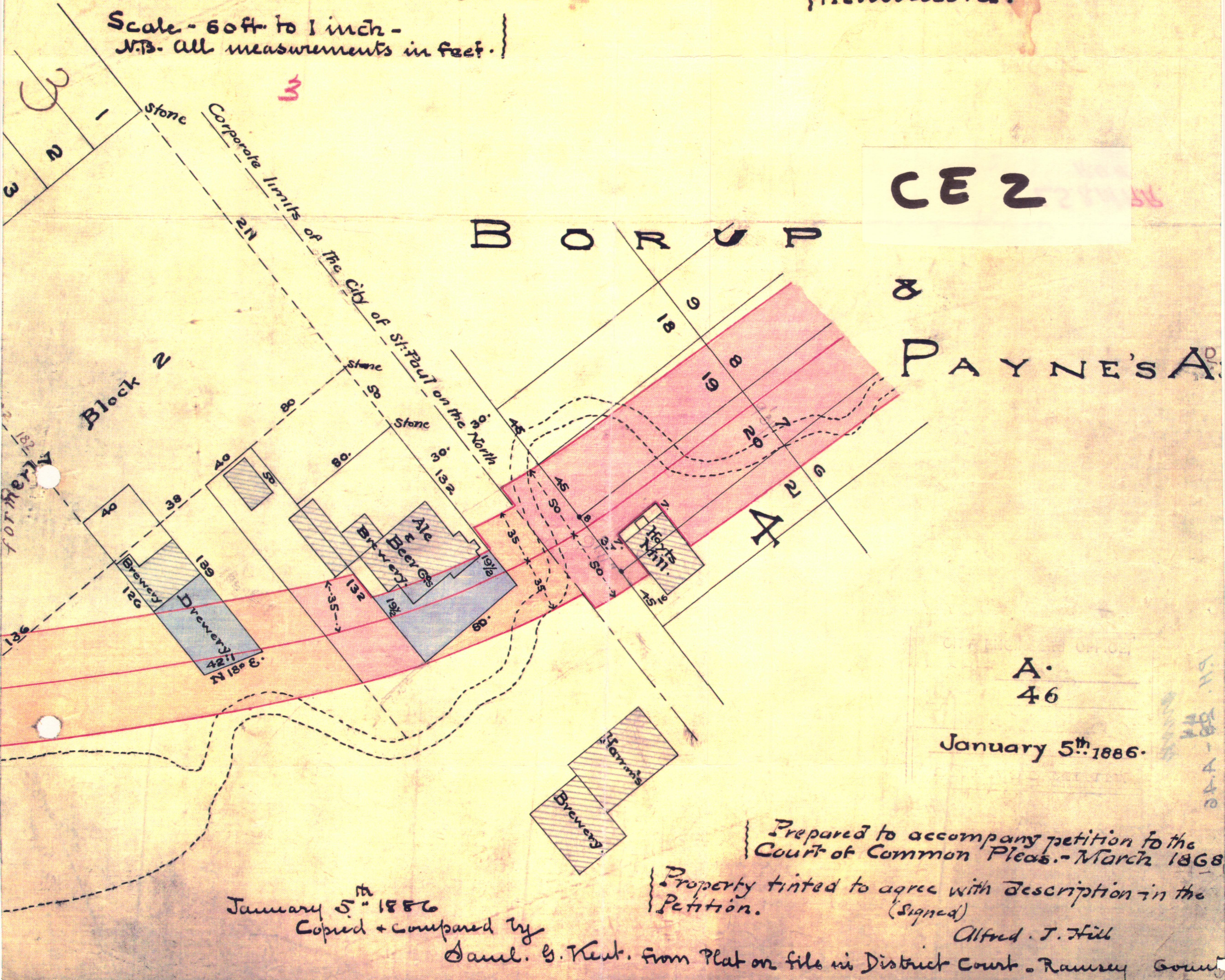

CE 2

CE 2

BORUP
&
PAYNE'S A.P.

A.
46
January 5th 1886.

January 5th 1886
Copied + compared by
Saml. G. Kent.

Prepared to accompany petition to the
Court of Common Pleas. - March 1868
Property tinted to agree with description in the
Petition.
(Signed)
Alfred J. Hill
from Plat on file in District Court - Ramsey County