

Scale 30 ft. per inch

PLAT OF SURVEY OF LOTS 1-2-3-4-5-6; THE SOUTHWESTLY 38 FT. OF LOT 7; THE SOUTHWESTLY 30 FT. OF LOT 8, ALL IN HORACE THOMPSON'S SUBN. OF BLOCK 4 HOYT'S ADDN. TO ST. PAUL; THE NORTHWESTLY 100 FT. OF LOT 3 BLOCK 3 HOYT'S ADDN. TO ST. PAUL AND LOT 6 AUDITORS SUBN. N^o 24. ST. PAUL, MINN.

December 27th 1954
 J. A. ... Civil Engr.

ABSTRACT OF TITLE

MADE BY OFFICIAL OFFICE OF RAMSEY COUNTY

No. 1

TO

The Easterly 30 feet of Lot 5 and the Westerly 25 feet of Lot 6,
Horace Thompson's Subdivision of Block 4, Hoyt's Addition to St. Paul

Premises described in caption are located in the NE 1/4 of SE 1/4
of Section Number 31 Township Number 29 North of
Range Number 22 West of the Fourth Principal Meridian.

SECTION

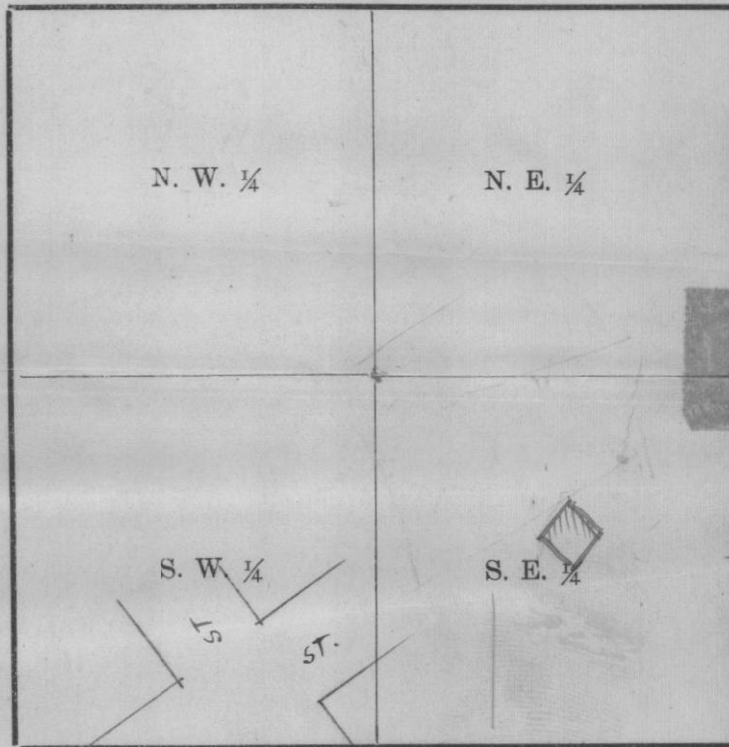

No. 2

Old Time Surveyors Measure

- $7\frac{92}{100}$ inches make 1 Link.
- 100 Links, or 66 feet, 1 Chain.
- 3 feet, 1 Yard.
- $5\frac{1}{2}$ yds. or $16\frac{1}{2}$ ft., 1 Rod or Pole.
- 4 Rods, 1 Chain,
- 80 Chains (5280 feet) 1 Mile.

No. 3

