

ST.

WABASHA

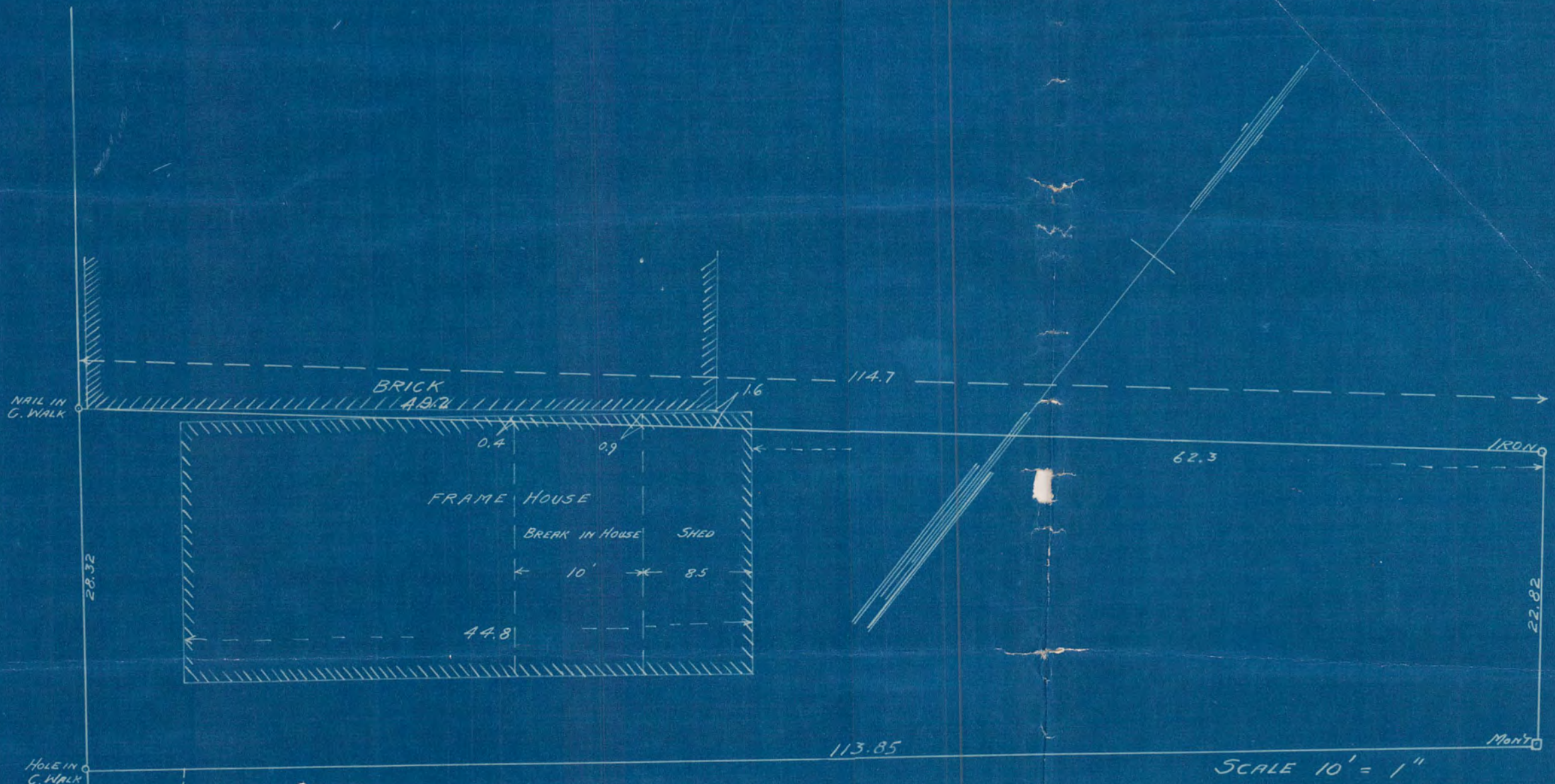

STATE OF MINNESOTA } S.S.  
 COUNTY OF RAMSEY

J. H. Armstrong being duly sworn doth depose and say that he is a resident of the City of St. Paul, County of Ramsey and State of Minnesota and a Civil Engineer by profession. He further deposes and says that on the 10<sup>th</sup> day of February A. D. 1911 he made a survey of the premises and real estate shown on this diagram, the same being described as follows:  
 "Commencing at a point on the E'y line of Wabasha St. distant 410.25 ft. N'y from the N.E. Cor. of Wabasha St. and College Ave, said point being the N.W'y Cor. of Lot 5, Block 2, Bazille's Add. to St. Paul; from said point running N.E'y along the N'y line of Lot 5, Block 2, Bazille's Add. as said line has been fixed and established by this stipulation and agreement at an angle with Wabasha St. of 89° 54' to the left a distance of 113.85 feet to the center of a Granite Monument in the boundary line between Lot 3, Block 2, Bazille's Add. and Lot 5, Block 2 of said addition; thence in a N.W'y direction along said E'y line 22.82 ft. to a point; thence in a S.W'y direction 114.7 ft. to the E'y line of Wabasha St; thence S'y along said E'y line of Wabasha St. 29.32 ft. to the place of beginning"

He further deposes and says that the diagram above correctly represents said premises and is an accurate, correct and complete survey and diagram thereof as the same was surveyed by him aforesaid.

Subscribed and Sworn to before me  
 this day of February A.D. 1911.

*J. H. Armstrong C.E.*

Notary Public - Ramsey Co. Minn.  
 My Commission Expires

# 811