

SURVEY OF ... EXCEPT the West 907.85 FT.
 The N $\frac{1}{2}$ of S $\frac{1}{2}$ of N $\frac{1}{2}$ of SW $\frac{1}{4}$ of SW $\frac{1}{4}$ of Section 16 T 28 N R 23 W.
 Also Known as, EXCEPT The West 907.85 FT.
 The south 165 ft. of the North 495 ft. of the SW $\frac{1}{4}$ of SW $\frac{1}{4}$ Sec. 16 T 28 N R 23 W.

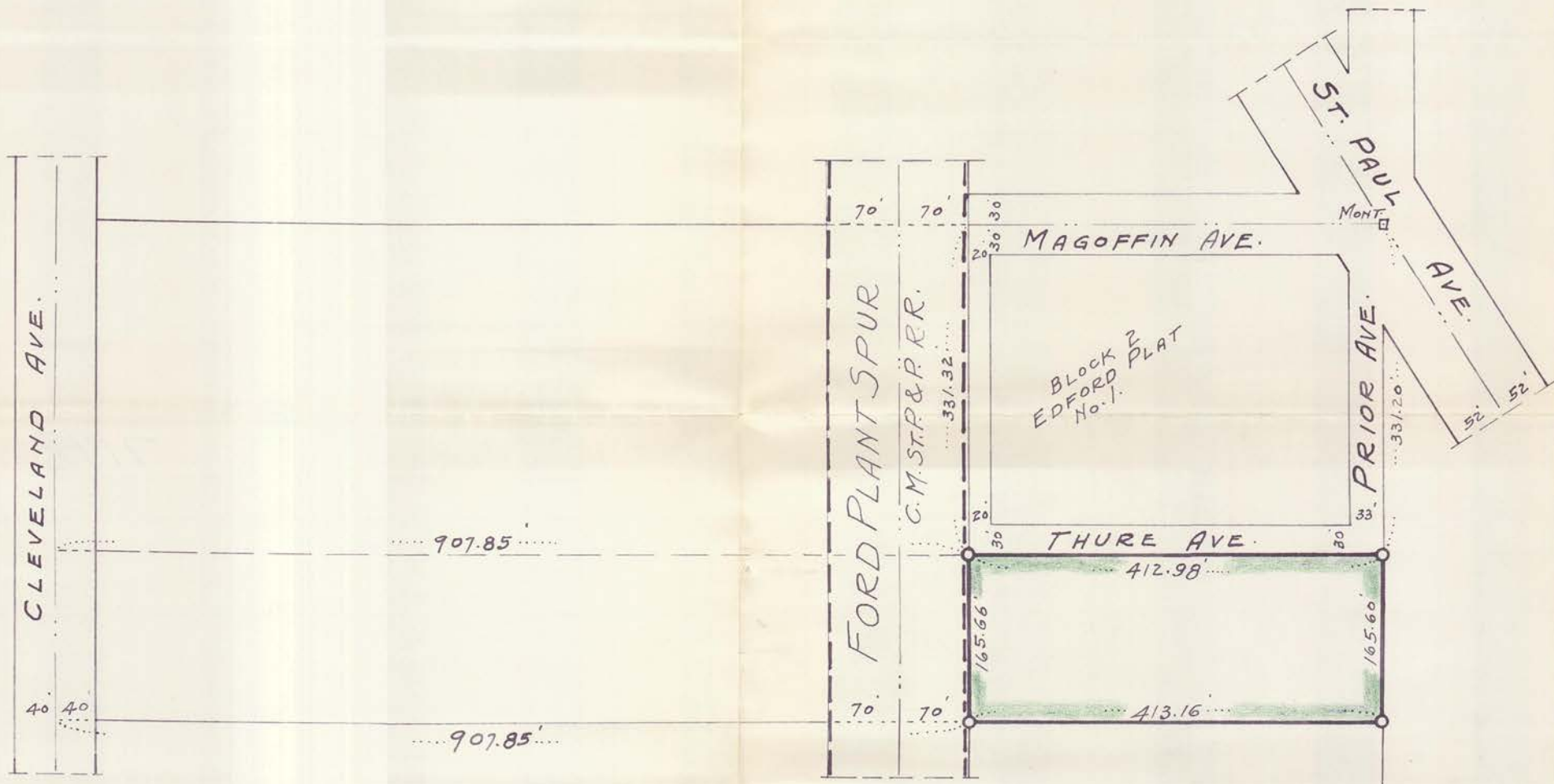

FORD PLANT SPUR OUTSIDE OF PROPERTY. NO ENCROACHMENTS.
 o - Indicates Iron.
 Scale 1" = 100 FT.

I hereby certify that this survey, plan, or report was prepared by me or under my direct supervision and that I am a duly Registered Land Surveyor under the laws of the State of Minnesota.

W. G. Ramlow

7-12-1951. 1150

ENGINEERING SERVICE CO.
 W. G. RAMLOW
 REG. SURVEYOR & ENGR.
 547 So. Saratoga St.
 ST. PAUL 5, MINN.
 July 12-1951.