

6738

OFFICE OF
MILNER W. CARLEY
ENGINEER - SURVEYOR
SURVEY OF
Lot 4 Blk. 31
Rice & Irvine's Addition

Oct. 1949

Scale 1" = 30'

o indicates iron

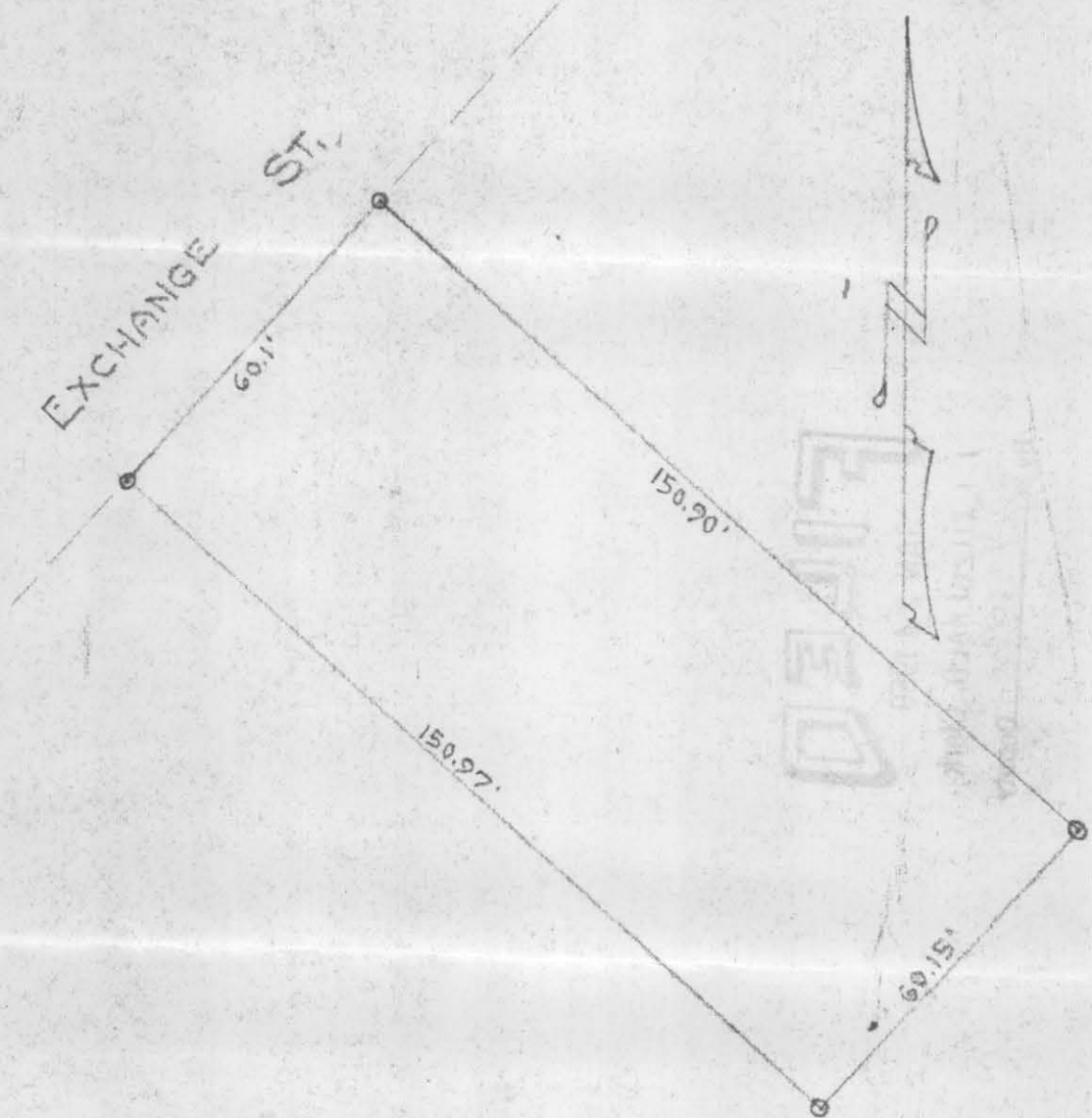

I hereby certify to having surveyed the property described on this map as Lot 4, Blk. 31, Rice & Irvine's Add. and have placed irons at the corners thereof as shown. There are no encroachments on this property.

Milner W. Carley

Registered Surveyor, Minnesota
Certificate No. 855.

6738