

2478

BANNING AND OLIVERS
 ADD
 SURVEY OF
 S 75 FT OF LOT 10 AND S 75 FT OF W 1/2 OF LOT 11 BL 47
 MAR 13 - 1920
 JENS PEDERSEN
 SURV.
 SCALE 20' = 1"

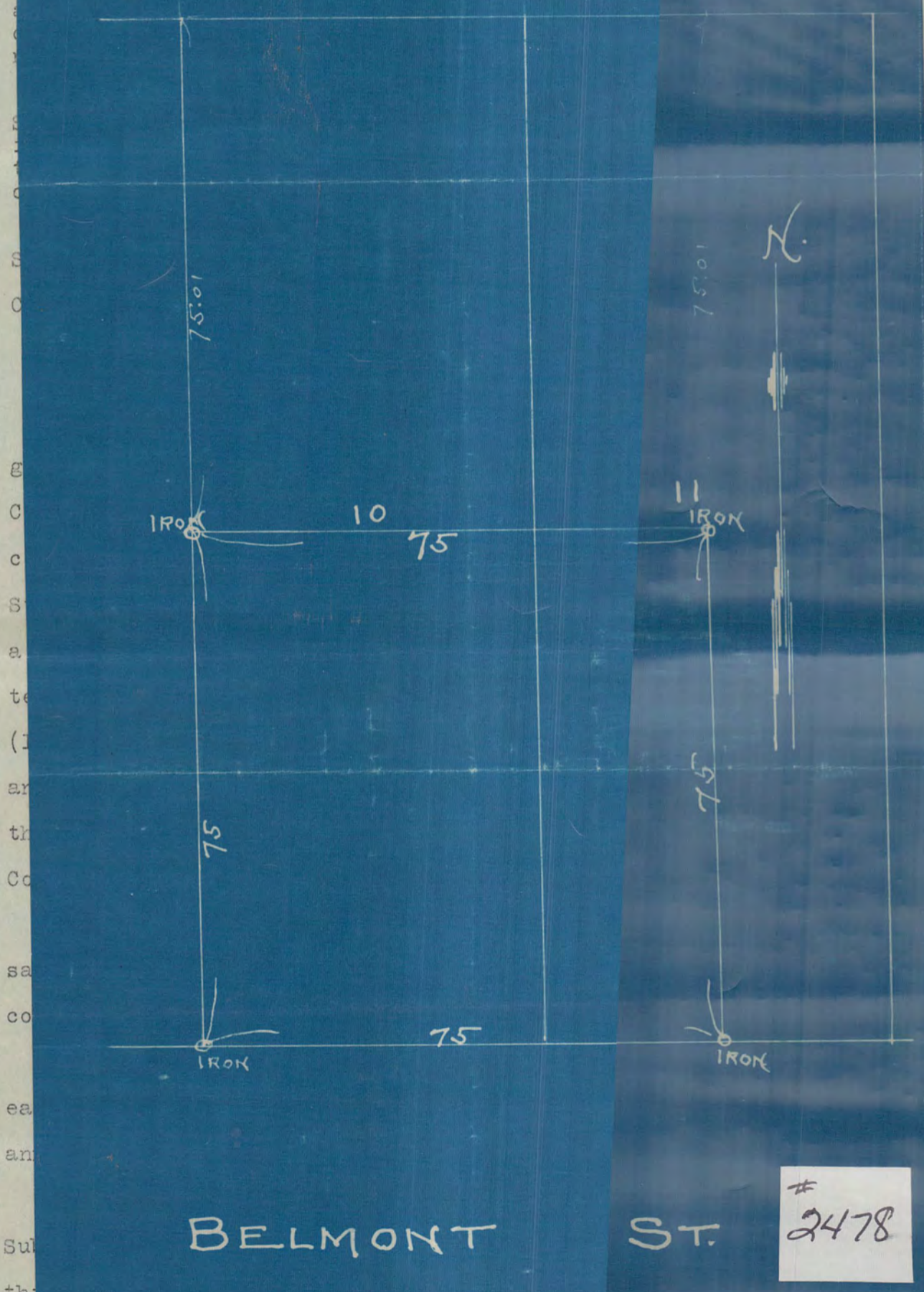

BELMONT

ST.

2478

R. M. Lawton
Notary Public, Ramsey County, Minn.

My commission expires April 14, 1927.

2478