

Exhibit A

# SURVEY OF

All that part of S. 1/2 of S.E. 1/4 of Sec. 33, T. 29, R. 22, described as follows, to-wit: - Commencing at the point where the Ely. line of Hester St. intersects the Nly. line of McLean Ave.; thence Ely. along the Nly. line of said McLean Ave.  $270\frac{63}{100}$  feet to the Wly. line of King's Addition, thence Nly. along said Wly. line of  $137\frac{98}{100}$  feet; thence Wly. parallel to the Nly. line of said McLean Ave  $269\frac{05}{100}$  ft. to the Ely. line of said Hester St.; thence Sly. along said Ely. line of Hester St.  $137\frac{98}{100}$  feet to point of beginning.

Nov., 30, 1917.

JENS PEDERSEN  
SURVEYOR & CIVIL ENGINEER.

SCALE 1"=50'

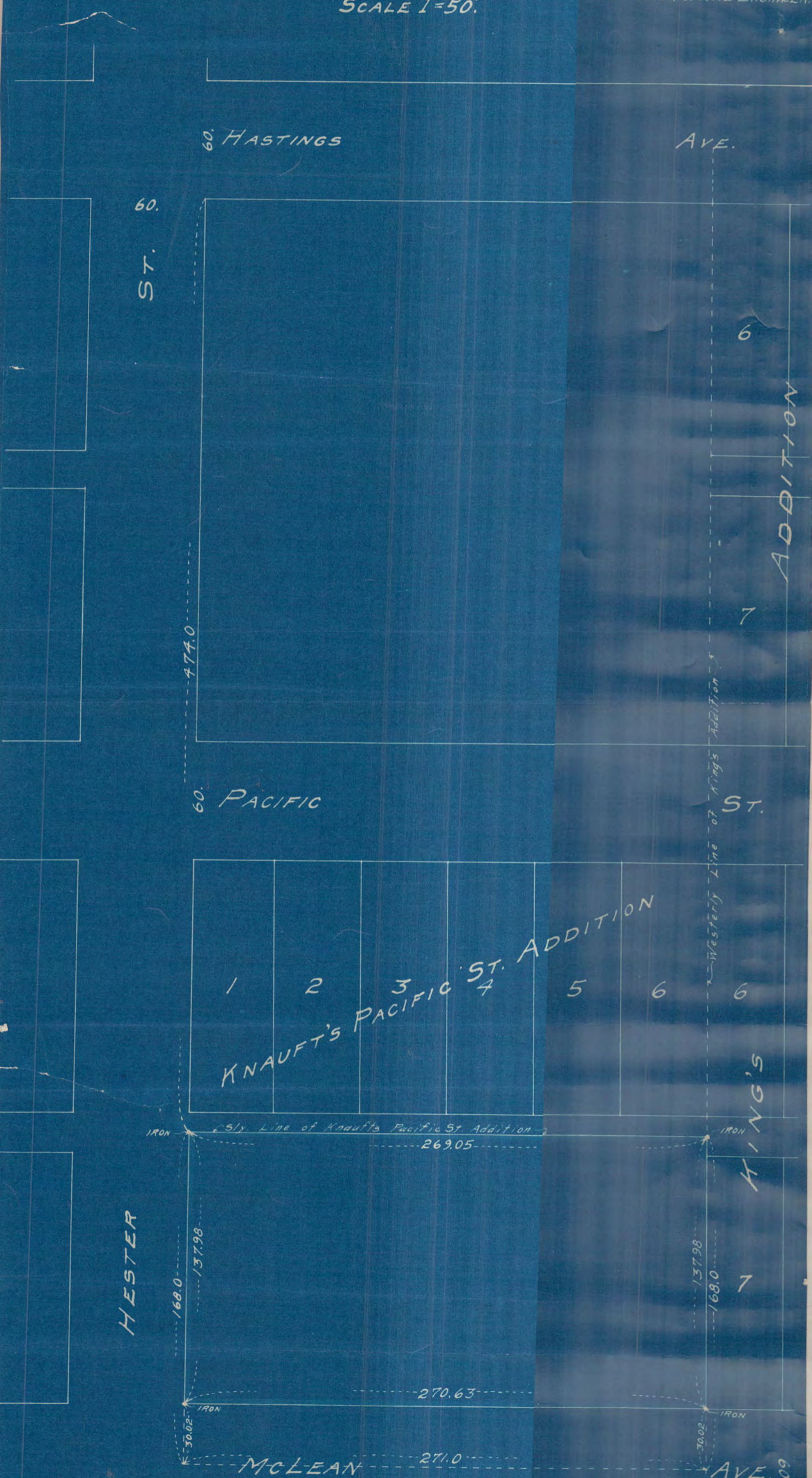

# 2097