

~~1456~~
1457

ABSTRACT OF TITLE

MADE BY OFFICIAL OFFICE OF RAMSEY COUNTY

No. 1

TO

Lots 12, 13 and 14, Block 2, Minnesota Transfer Addition, St. Paul
Minn. Also,

Lots 29 and 30, Block 2, of said addition. (See Nos. 97 to 125.)

Premises described in caption are located in the E 1/2 of SE 1/4
of Section Number 29 Township Number 29 North of
Range Number 23 West of the Fourth Principal Meridian.

SECTION

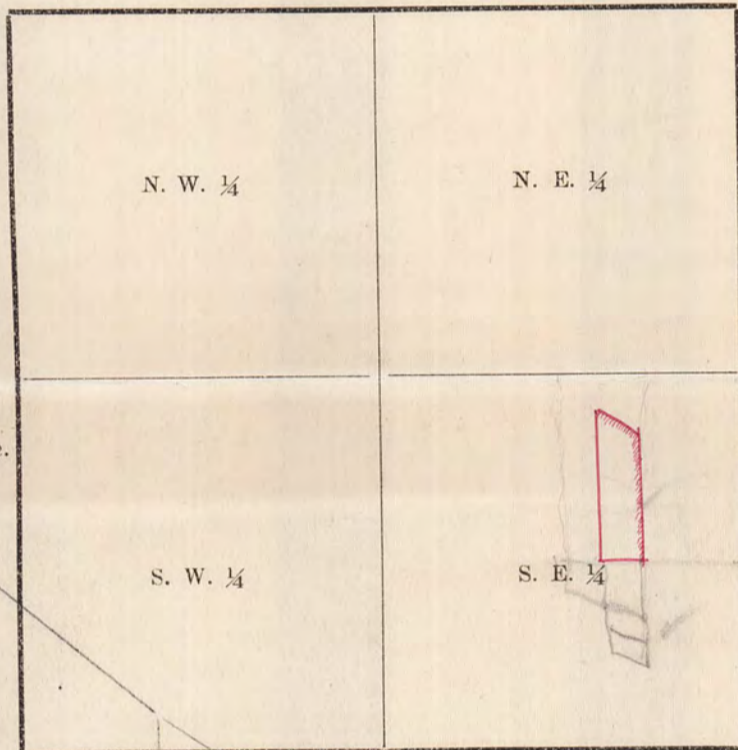

No. 2

Old Time Surveyors Measure

- $\frac{7^{92}}{100}$ inches make 1 Link.
- 100 Links, or 66 feet, 1 Chain.
- 3 feet, 1 Yard.
- $5\frac{1}{2}$ yds. or $16\frac{1}{2}$ ft., 1 Rod or Pole.
- 4 Rods, 1 Chain.
- 80 Chains (5280 feet) 1 Mile.

No. 3

AVE

HERSEY

RES

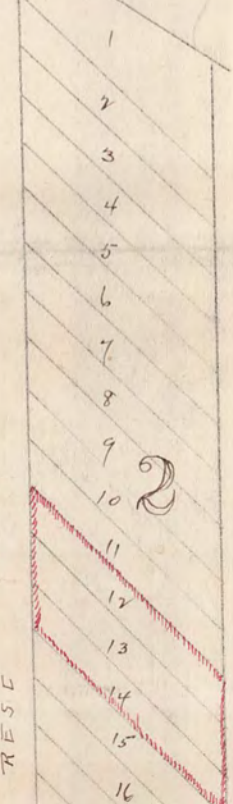

14 lots below 14
29
1457