

NORTHERN PACIFIC R.R.

LANGTRY AVE.

60

J.W. KEOUGH

AVE

1377
GRIFFIN WHEEL CO
LOT A
NORTHWESTERN WHEEL AND FOUNDRY CO'S
ADD.

SURVEY OF

ALL THAT PART OF SECTIONS TWENTY SEVEN (27) AND TWENTY EIGHT (28) TOWNSHIP TWENTY NINE (29) RANGE TWENTY TWO (22) DESCRIBED AS FOLLOWS TO-WIT: COMMENCING AT A POINT WHERE THE CENTER LINE OF PHALEN STREET INTERSECTS THE NORTHERLY LINE OF THE RIGHT OF WAY OF THE CHICAGO ST. PAUL, MINNEAPOLIS AND OMAHA RAILWAY; THENCE NORTHERLY ON THE CENTER LINE OF PHALEN STREET THREE HUNDRED AND SIXTY FIVE AND FIVE TENTHS (365.5) FEET TO THE CENTER LINE OF STILLWATER AVENUE; THENCE AT AN ANGLE OF SEVENTY DEGREES TWENTY MINUTES (70° 20') TO THE RIGHT ALONG THE CENTER LINE OF STILLWATER AVENUE TWO HUNDRED TWELVE AND TWENTY THREE ONE HUNDREDS (212.23) FEET TO THE INTERSECTION OF THE CENTER LINE OF STILLWATER AVENUE AND THE CENTER LINE OF CORNING AVENUE; THENCE NORTHERLY AT AN ANGLE OF EIGHTY THREE DEGREES THIRTEEN MINUTES (83° 13') TO THE LEFT ALONG THE CENTER LINE OF CORNING AVENUE TWO HUNDRED THIRTY EIGHT (238) FEET; THENCE WESTERLY AT AN ANGLE OF NINETY ONE DEGREE ELEVEN MINUTES (91° 11') TO THE LEFT ONE HUNDRED FORTY ONE AND FORTY NINE ONE HUNDREDS (141.49) FEET; THENCE SOUTHERLY AT AN ANGLE OF NINETY (90°) DEGREES TO THE LEFT A DISTANCE OF TWENTY (20) FEET; THENCE WESTERLY AT AN ANGLE OF NINETY (90°) DEGREES TO THE RIGHT A DISTANCE OF TEN (10) FEET; THENCE SOUTHERLY AT AN ANGLE OF NINETY (90°) DEGREES TO THE LEFT ALONG THE CENTER LINE OF A PARTY WALL NOW LOCATED ON SAID LINE A DISTANCE OF FOURTEEN AND FIFTEEN ONE HUNDREDS (141.5) FEET; THENCE WESTERLY AT AN ANGLE OF NINETY (90°) DEGREES TO THE RIGHT A DISTANCE OF TEN (10) FEET; THENCE SOUTHERLY AT AN ANGLE OF NINETY (90°) DEGREES TO THE LEFT A DISTANCE OF NINETEEN (19) FEET; THENCE WESTERLY AT AN ANGLE OF NINETY (90°) DEGREES TO THE RIGHT A DISTANCE OF ONE HUNDRED FOURTEEN AND THIRTY NINE ONE HUNDREDS (114.39) FEET TO THE EASTERLY BOUNDARY LINE OF LOT A NORTHWESTERN WHEEL AND FOUNDRY COMPANY'S ADDITION. ACCORDING TO THE RECORDED PLAT THEREOF ON FILE IN THE OFFICE OF THE REGISTER OF DEEDS OF RAMSEY COUNTY, MINNESOTA; THENCE SOUTHERLY ALONG THE EASTERLY BOUNDARY LINE OF SAID LOT A A DISTANCE OF SEVEN HUNDRED TWENTY ONE AND FIFTY SEVEN ONE HUNDREDS (721.57) FEET MORE OR LESS TO THE NORTHERLY BOUNDARY LINE OF THE RIGHT OF WAY OF THE CHICAGO ST. PAUL, MINNEAPOLIS AND OMAHA RAILWAY; THENCE EASTERLY ALONG THE NORTHERLY BOUNDARY LINE OF SAID RIGHT OF WAY TWO HUNDRED EIGHTY TWO AND TWO TENTHS (282.2) FEET, TO THE POINT OF BEGINNING.

Jens Pedersen
SURVEYOR
210 GLOBE BLDG

KOEHLER AND HEINDRICHS

CORNING

STILLWATER

AVE

ST

Exhibit A



SCALE 30' = 1"

PHALEN

KOEHLER AND HEINDRICHS
GRIFFIN WHEEL CO
YENDEE

RIGHT OF WAY C. ST. P. M. AND O. RY.

NORTHERN PACIFIC R.R.

LANGTRY AVE.

J.W. KEOUGH

AVE

GRIFFIN WHEEL CO.
LOT A
NORTHWESTERN WHEEL AND FOUNDRY CO'S
ADD.

KOEHLER AND HEINDRICHS

CORNING

AVE.

SURVEY OF

ALL THAT PART OF SECTIONS TWENTY SEVEN (27) AND TWENTY EIGHT (28) TOWNSHIP TWENTY NINE (29) RANGE TWENTY TWO (22) DESCRIBED AS FOLLOWS TO-WIT: COMMENCING AT A POINT WHERE THE CENTER LINE OF PHALEN STREET INTERSECTS THE NORTHERLY LINE OF THE RIGHT OF WAY OF THE CHICAGO ST. PAUL MINNEAPOLIS AND OMAHA RAILWAY; THENCE NORTHERLY ON THE CENTER LINE OF PHALEN STREET THREE HUNDRED AND SIXTY FIVE AND FIVE TENTHS (365.5) FEET TO THE CENTER LINE OF STILLWATER AVENUE; THENCE AT AN ANGLE OF SEVENTY DEGREES TWELVE MINUTES (70°12') TO THE RIGHT ALONG THE CENTER LINE OF STILLWATER AVENUE TWO HUNDRED TWELVE AND TWENTY THREE ONE HUNDREDS (212.23) FEET TO THE INTERSECTION OF THE CENTER LINE OF STILLWATER AVENUE AND THE CENTER LINE OF CORNING AVENUE PRODUCED; THENCE NORTHERLY AT AN ANGLE OF EIGHTY THREE DEGREES THIRTEEN MINUTES (83°13') TO THE LEFT ALONG THE CENTER LINE OF CORNING AVENUE TWO HUNDRED THIRTY EIGHT (238) FEET; THENCE WESTERLY AT AN ANGLE OF NINETY ONE DEGREE ELEVEN MINUTES (91°11') TO THE LEFT ONE HUNDRED FORTY ONE AND FORTY NINE ONE HUNDREDS (141.49) FEET; THENCE SOUTHERLY AT AN ANGLE OF NINETY (90°) DEGREES TO THE LEFT A DISTANCE OF TWENTY (20) FEET; THENCE WESTERLY AT AN ANGLE OF NINETY (90°) DEGREES TO THE RIGHT A DISTANCE OF TEN (10) FEET; THENCE SOUTHERLY AT AN ANGLE OF NINETY (90°) DEGREES TO THE LEFT ALONG THE CENTER LINE OF A PARTY WALL NOW LOCATED ON SAID LINE A DISTANCE OF FOURTEEN AND FIFTEEN ONE HUNDREDS (14.15) FEET; THENCE WESTERLY AT AN ANGLE OF NINETY (90°) DEGREES TO THE RIGHT A DISTANCE OF TEN (10) FEET; THENCE SOUTHERLY AT AN ANGLE OF NINETY (90°) DEGREES TO THE LEFT A DISTANCE OF NINETEEN (19) FEET; THENCE WESTERLY AT AN ANGLE OF NINETY (90°) DEGREES TO THE RIGHT A DISTANCE OF ONE HUNDRED FOURTEEN AND THIRTY NINE ONE HUNDREDS (114.39) FEET TO THE EASTERLY BOUNDARY LINE OF LOT A NORTHWESTERN WHEEL AND FOUNDRY COMPANY'S, ADDITION ACCORDING TO THE RECORDED PLAT THERE OF ON FILE IN THE OFFICE OF THE REGISTER OF DEEDS OF RAMSEY COUNTY, MINNESOTA; THENCE SOUTHERLY ALONG THE EASTERLY BOUNDARY LINE OF SAID LOT A A DISTANCE OF SEVEN HUNDRED TWENTY ONE AND FIFTY SEVEN ONE HUNDREDS (721.57) FEET MORE OR LESS TO THE NORTHERLY BOUNDARY LINE OF THE RIGHT OF WAY OF THE CHICAGO ST. PAUL MINNEAPOLIS AND OMAHA RAILWAY; THENCE EASTERLY ALONG THE NORTHERLY BOUNDARY LINE OF SAID RIGHT OF WAY TWO HUNDRED EIGHTY TWO AND TWO TENTHS (282.2) FEET TO THE POINT OF BEGINNING.

Jens Pedersen
SURVEYOR
210 GLOBE BLDG

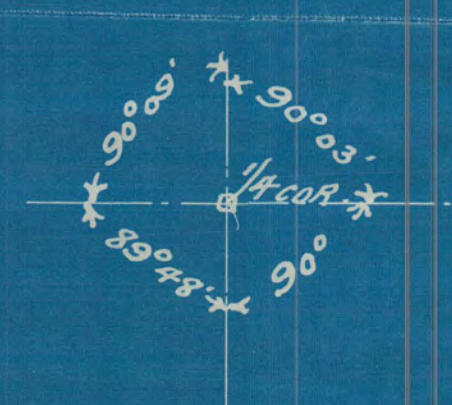

SEC 28
207.88
SEC 27

KOEHLER AND HEINDRICHS
GRIFFIN WHEEL CO
YENDEE

PHALEN ST

RIGHT OF WAY C. ST. P. M. AND O. RY.

