

WALCOTT'S

15

21

ADDITION TO COTTAGE HOMES

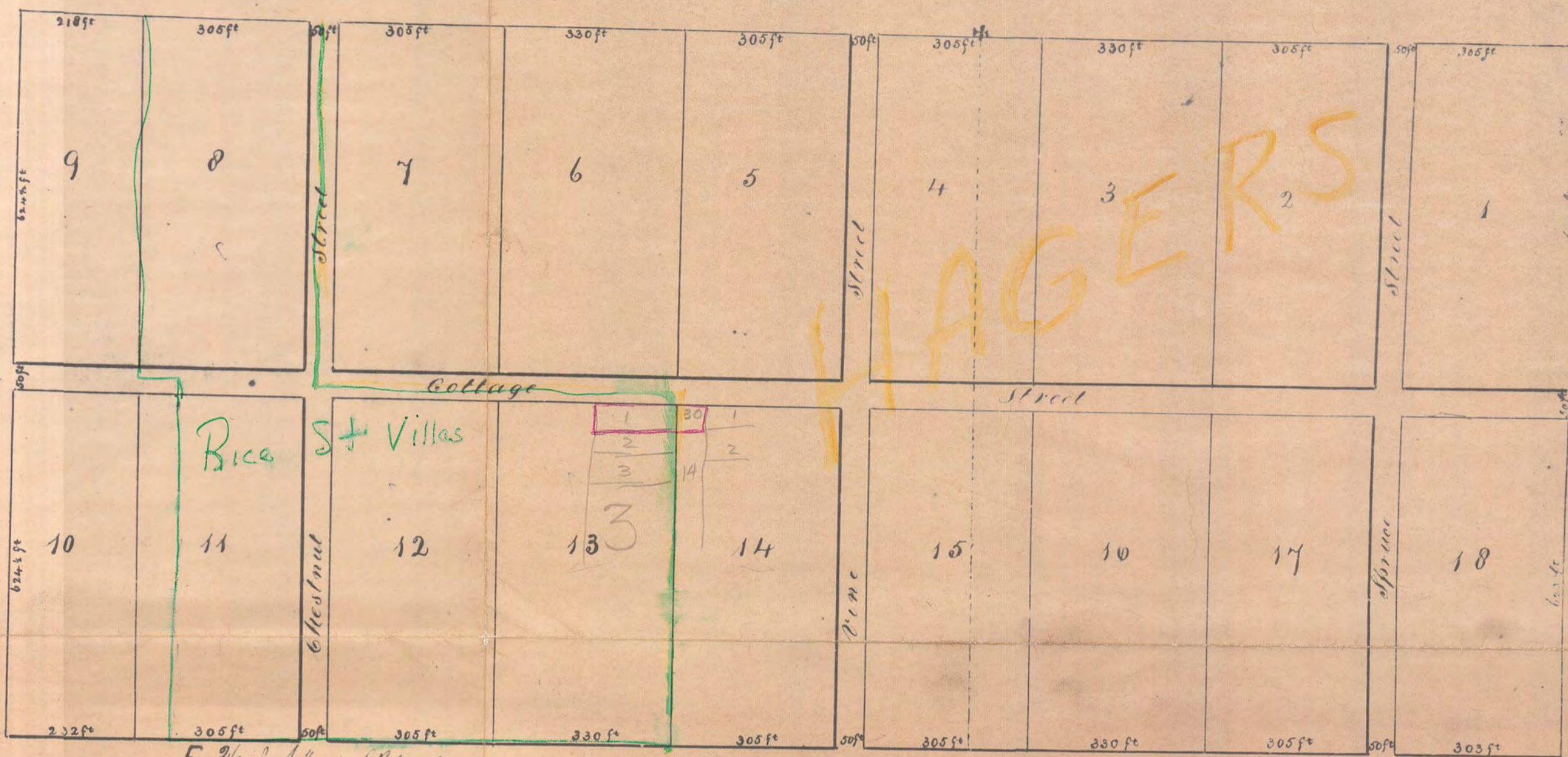

E 1/2 of N 1/2 of S 24 Township 29 Range 23

N 1/2 of S 24 Township 29 Range 23

We hereby certify that the annexed is a correct plat of Walcott's Addition to Cottage Homes as surveyed by us in the month of July 1856 the same consisting of the east two thirds of the North half of the South east quarter of section No twenty four in Township No twenty nine North of Range No twenty three West, and the North West quarter of the South East quarter of section No nineteen in Township No twenty nine North of Range No twenty two West, containing altogether according to Gov survey eighty seven 1/100 acres. All lots contain according to Gov survey five acres including streets except lots No 9 & 10 which contain three 5/100 acres.

William Johnson
Civil Engineers & Surveyors

Office of Register of Deeds
County of Ramsey
I hereby certify that the above is a true copy of the certificate in the Original plat of Walcott's Addition to Cottage Homes as filed in this office on the 5th day of August A.D. 56. It is recorded here as a portion of the same as submitted by the Register in the first record.
Dated Aug 5th A.D. 1856
Edwin Keenan Reg. of Deeds
per Thomas Lyons deputy

Office of Register of Deeds
County of Ramsey
I hereby certify that the above is a true and correct copy of the Original plat of Walcott's Addition to Cottage Homes as filed in this office on the 5th day of August A.D. 1856.
Lewis M. Oliver
Reg. of Deeds
per J. S. Oliver Deputy

We hereby certify that the annexed is a correct plat of Walcott's Addition to Cottage Homes as surveyed by us in the month of July 1856, the same consisting of the east two thirds of the North half of the South east quarter of section No twenty four in Township No twenty nine North of Range No twenty three West, containing altogether according to Gov. Survey Eighty seven 1/100 Acres.

All lots contain according to Gov. Survey five acres including streets, except lots No 9 & 10 which contain three 5/100 Acres.

William Johnson
Civil Engineers and Surveyors.

Know all men by these presents that I, Henry H. Kenty of Saint Paul in the County of Ramsey & Territory of Minnesota, did on the 23rd day of July A.D. 1856, authorize William Johnson, Surveyor, to survey the foregoing plat, to survey & plat a tract of land situated in the County of Ramsey aforesaid, to be called Walcott's Addition to Cottage Homes, as herein appears, and do hereby release all my right title, interest and claim in and to the Roadways or Avenues as laid out on the foregoing plat, and give the same for public use.

Dated Saint Paul }
August 4th 1856 }
H. H. Kenty
Wm. Johnson
J. S. Oliver

Territory of Minnesota }
County of Ramsey }
Be it known that on this

4th day of August 1856, before me the undersigned personally came Henry H. Kenty, whose signature appears to the above instrument of writing, and who is personally known to me, the acknowledged that he signed the same freely & voluntarily for the uses & purposes therein expressed.

E. J. Way
Notary Public, Minnesota.

Through Ramsey's Addition to Cottage Homes as shown in the plat being in and according to the survey made by William Johnson, Surveyor, on the 23rd day of July 1856.

Office of Register of Deeds
County of Ramsey
I hereby certify that the above is a true and correct copy of the Original plat of Walcott's Addition to Cottage Homes as filed in this office on the 5th day of August A.D. 1856.

Office of Register of Deeds
County of Ramsey
I hereby certify that the above is a true and correct copy of the Original plat of Walcott's Addition to Cottage Homes as filed in this office on the 5th day of August A.D. 1856.