

~ PLAT OF SURVEY ~

Lots 16-17-18-19 and 20 and Lots 9-10-11 all in Block 2, Hazel Park Plat "B", except part taken for Railway.

30 foot Sewer Easement:

From a point on the South line of Lot 17 distant 3 feet West of the Southeast corner of said Lot; thence running along a straight line in a Northeasterly direction to a point on the North line of Lot 9, a distance of 14 feet East of the Northwest corner of Lot 9.

Scale: 1" = 30'

Note: No Irons Set.

NORTH

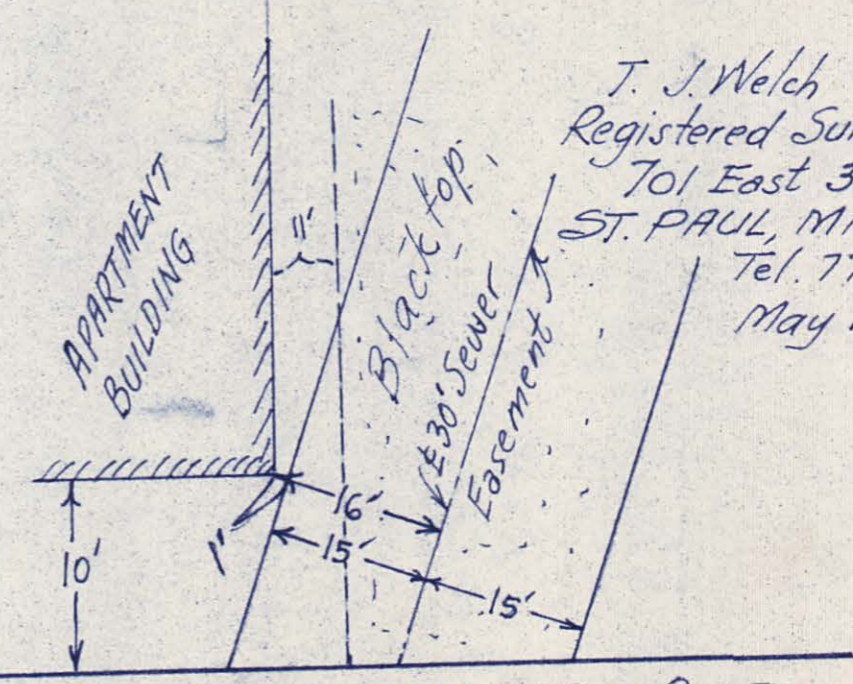

~ DETAIL ~
Not to Scale

T. J. Welch
Registered Surveyor
701 East 3rd St.
ST. PAUL, MINN. 55106
Tel. 776-0640
May 19, 1973