

11298
R# 379

RIVERVIEW INDUSTRIAL
Part between Alabama, Florida, Georgia and
VACATION
City of St. Paul
Dep. of Public Works
May 24, 1966
Scale: 1"=300'



RIVERVIEW INDUSTRIAL
VACATION
MAY 24, 1966

500374

JUNE 15, 1966

480386

11298
R# 379

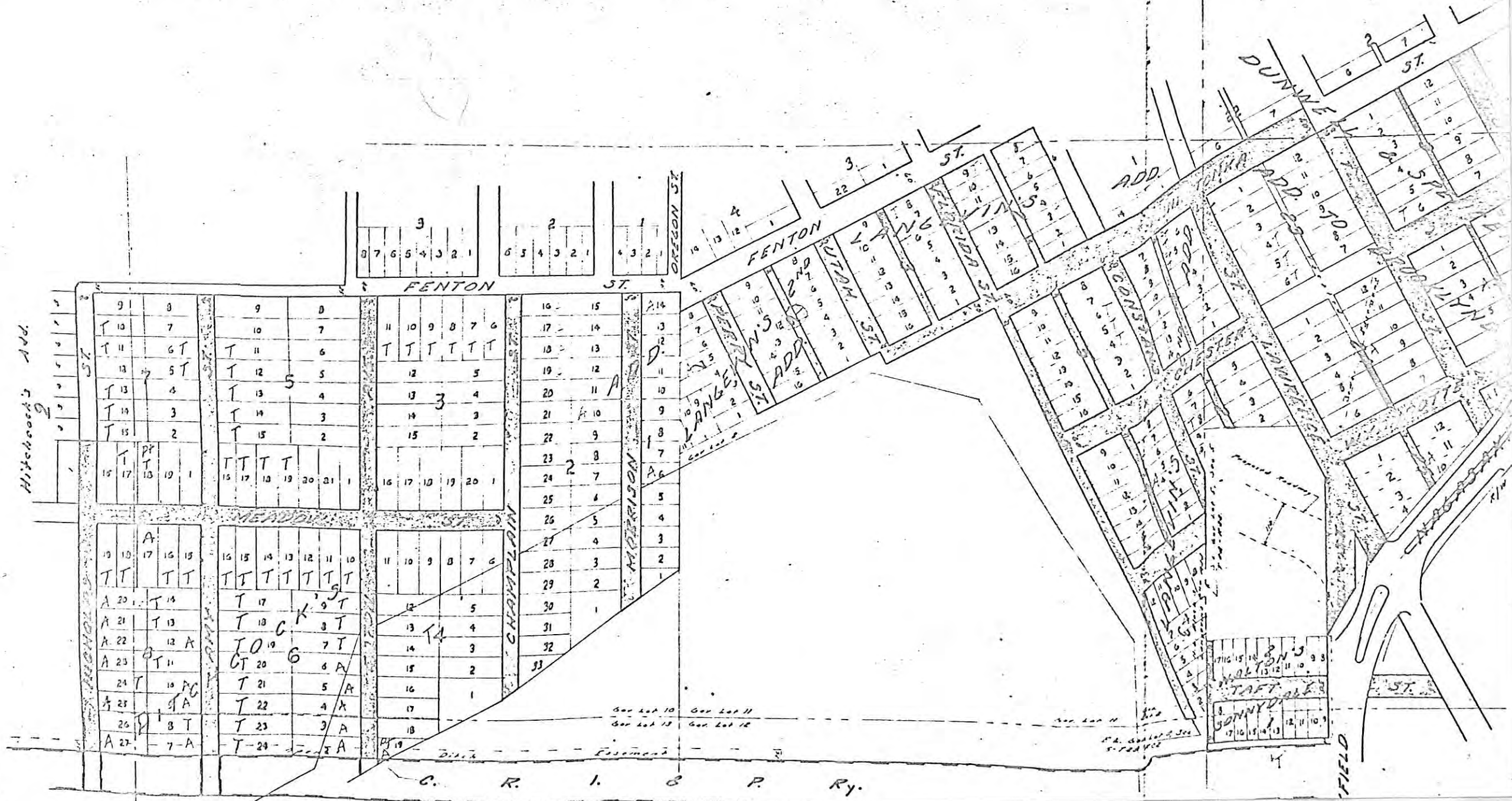

11298

PROJECT AREA 1-A

11298
R# 379

PROCEEDING NO. 27
LANGEVIN'S 2ND ADDITION

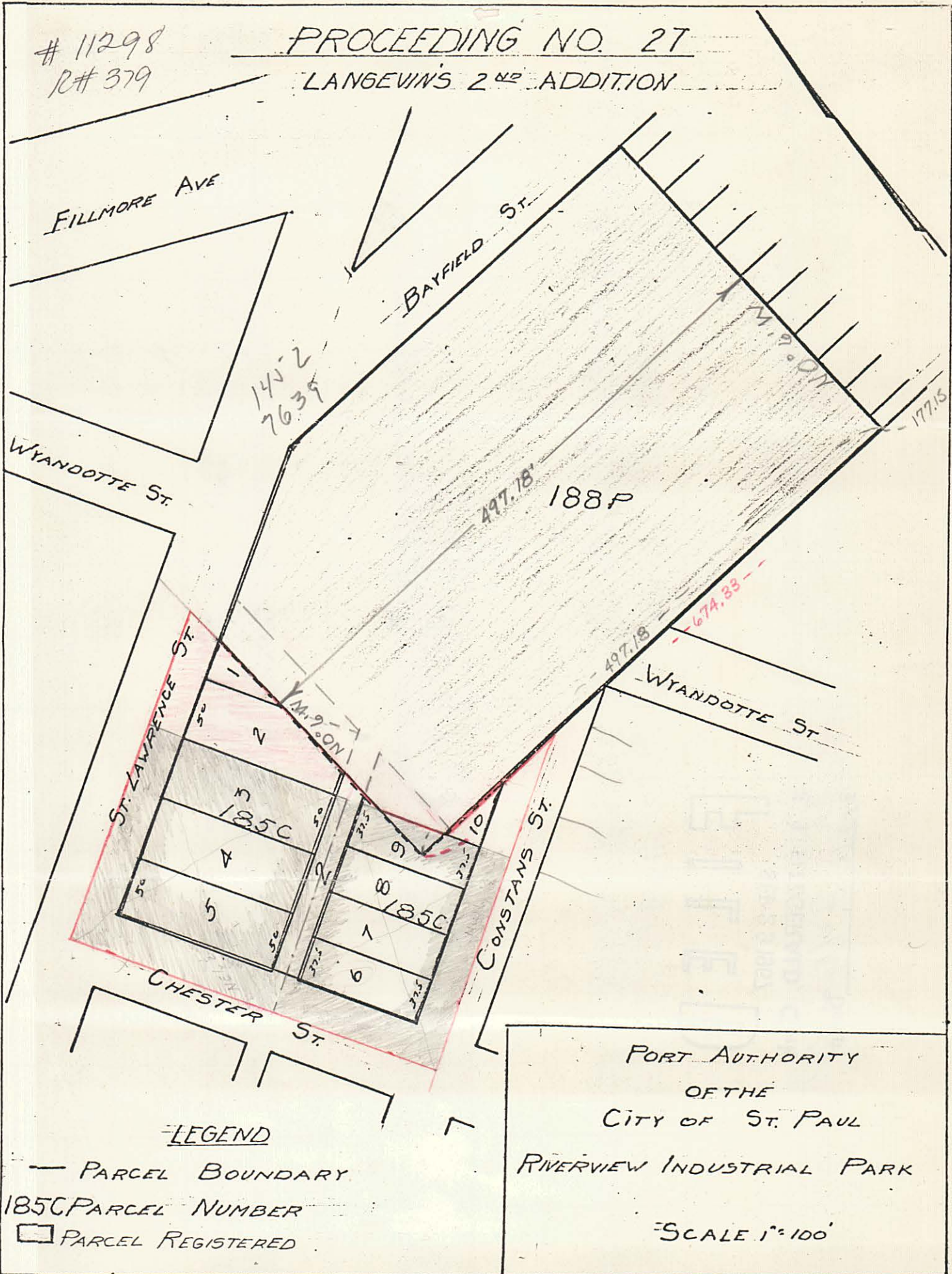

SECURITY
L.S.

177.15
497.18
674.33

LEGEND

- PARCEL BOUNDARY
- 185C PARCEL NUMBER
- PARCEL REGISTERED

PORT AUTHORITY
OF THE
CITY OF ST. PAUL

RIVERVIEW INDUSTRIAL PARK

SCALE 1"=100'