

Exclusively for the St. Paul Fed. Savings & Loan Assn.

THE E. B. McDONOUGH CO.

1953 UNIVERSITY AVE., SAINT PAUL 4  
406 NATIONAL BUILDING, MINNEAPOLIS 2

TELEPHONES { FE. 5-6611  
MI. 6-6858  
MI. 9-5072

SCALE: 1 INCH 20 FEET

# PLAT OF SURVEY

OF PROPERTY OF Bix, Max & Betty - 1839 E. Ivy Ave., St. Paul

DESCRIBED AS FOLLOWS Lots 43 and 44 in Block 16 in Hayden Heights,  
Ramsey Co.

10344

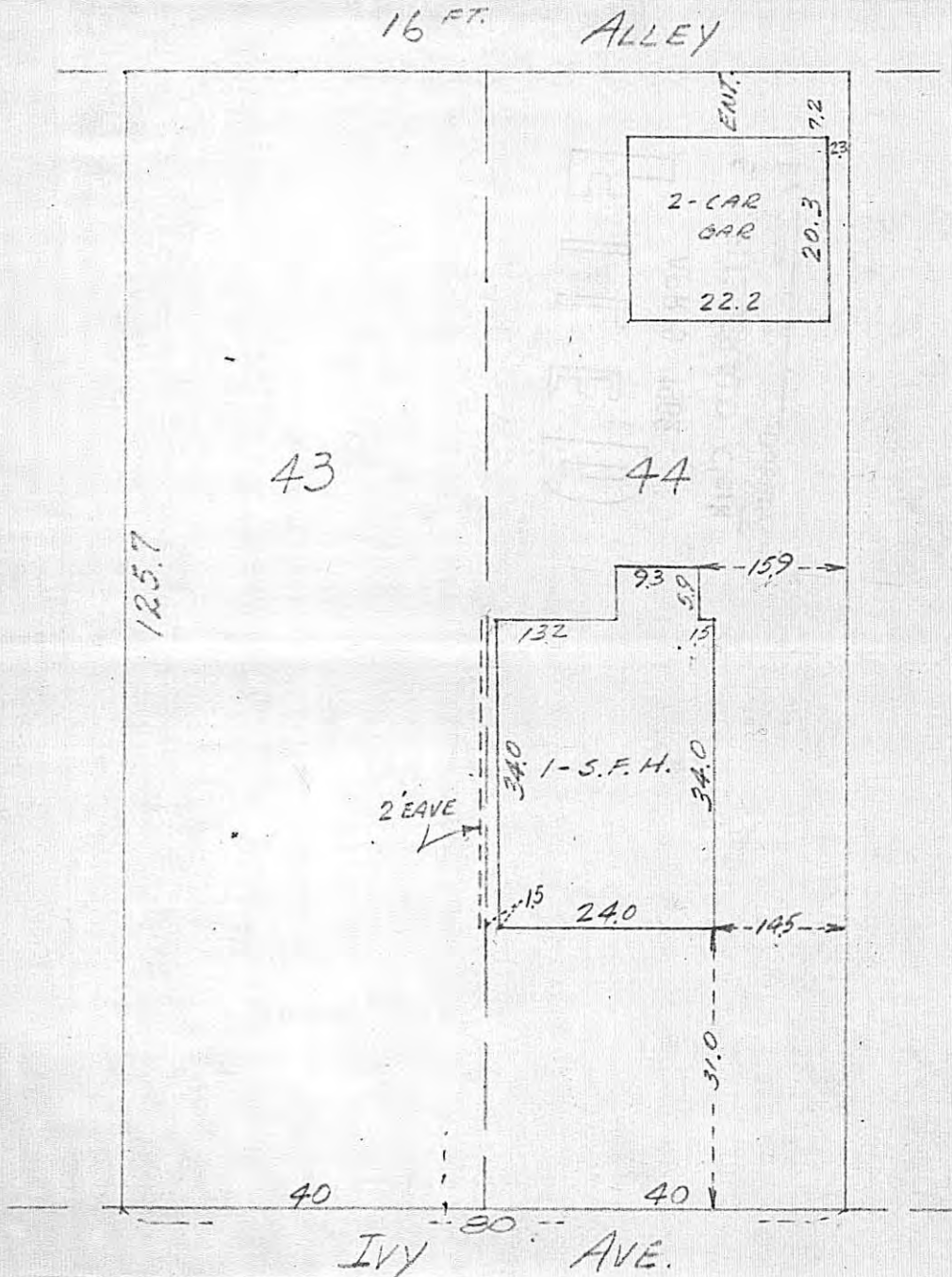

### CERTIFICATE OF LOCATION OF BUILDING

I hereby certify that on 2-6-46 1961  
I made a survey of the location of the building(s) on the  
above described property and that the location of said  
building(s) is correctly shown on the above plat.

*Paul J. Crane*  
\_\_\_\_\_  
E. B. McDONOUGH, REGISTERED SURVEYOR. No. 1990  
PAUL J. CRANE, " " No. 4449  
JOHN J. RYAN, " " No. 4489

### CERTIFICATE OF SURVEY

I hereby certify that on \_\_\_\_\_ 19\_\_\_\_  
I surveyed the property described above and that the above  
plat is a correct representation of said survey.