

Section 4, T. 30., R. 23.

TOWN. 31.  
TOWN. 30.

CO.  
CO.

COUNTY ROAD I

NOTE: Parcel  
B on old map in  
has the same  
found on map 11  
33

8/3/99  
RICE  
CREEK  
CORPORATE  
PARK (5)

VIAIION FIELD "UNIVERSITY OF MINNESOTA"  
Gov't Lot 4  
Gov't Lot 3

FOR DETAIL  
SEE PLAT!!

St. A. Skiba  
118.00 Ac.

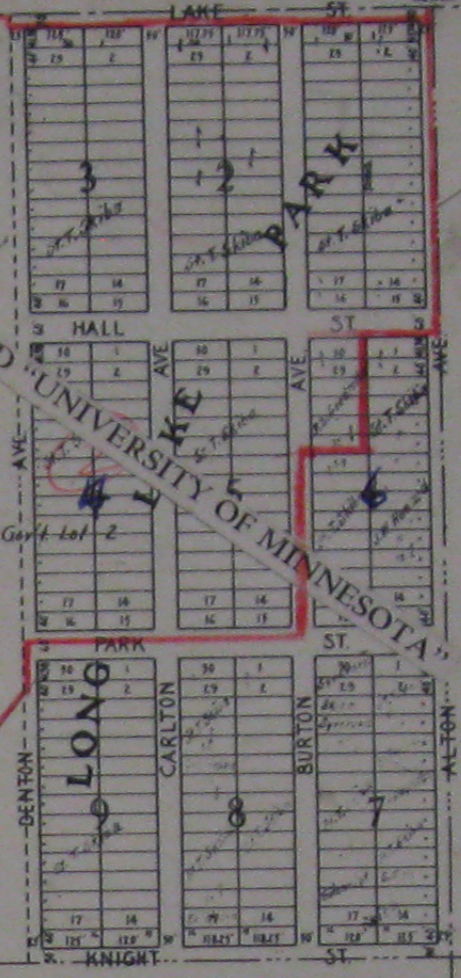

Gov't Lot 1  
J.C. Austin et al  
57.74 Ac.

MANSEY COUNTY  
OPEN SPACE

SCHUTTA

VIAIION FIELD "UNIVERSITY OF MINNESOTA"  
A Carlson  
40 Ac.

Geo. H. Elwell  
40 Ac.

R.G. Austin et al  
41.53 Ac.

5

3

10  
Stephen Szymezok  
40 Ac.

9  
40 Ac.

14  
40 Ac.

13  
Gen. H. Elwell  
40 Ac.

11  
Effie Trowbridge  
38.0 Ac.

12  
James H. Doherty  
38.0 Ac.

Geo. H. Elwell  
9.55 Ac.

John Dambrowski  
9.55 Ac.

Frank Wozniak  
28.0 Ac.

NOTE: PARCEL  
B is in  
to State, Minnesota  
and for  
See map of Minnesota

EDGETOWN ACRES  
A B D E F G  
A B C D E F G