

N. W. 1/4 Sec. 22—29—23

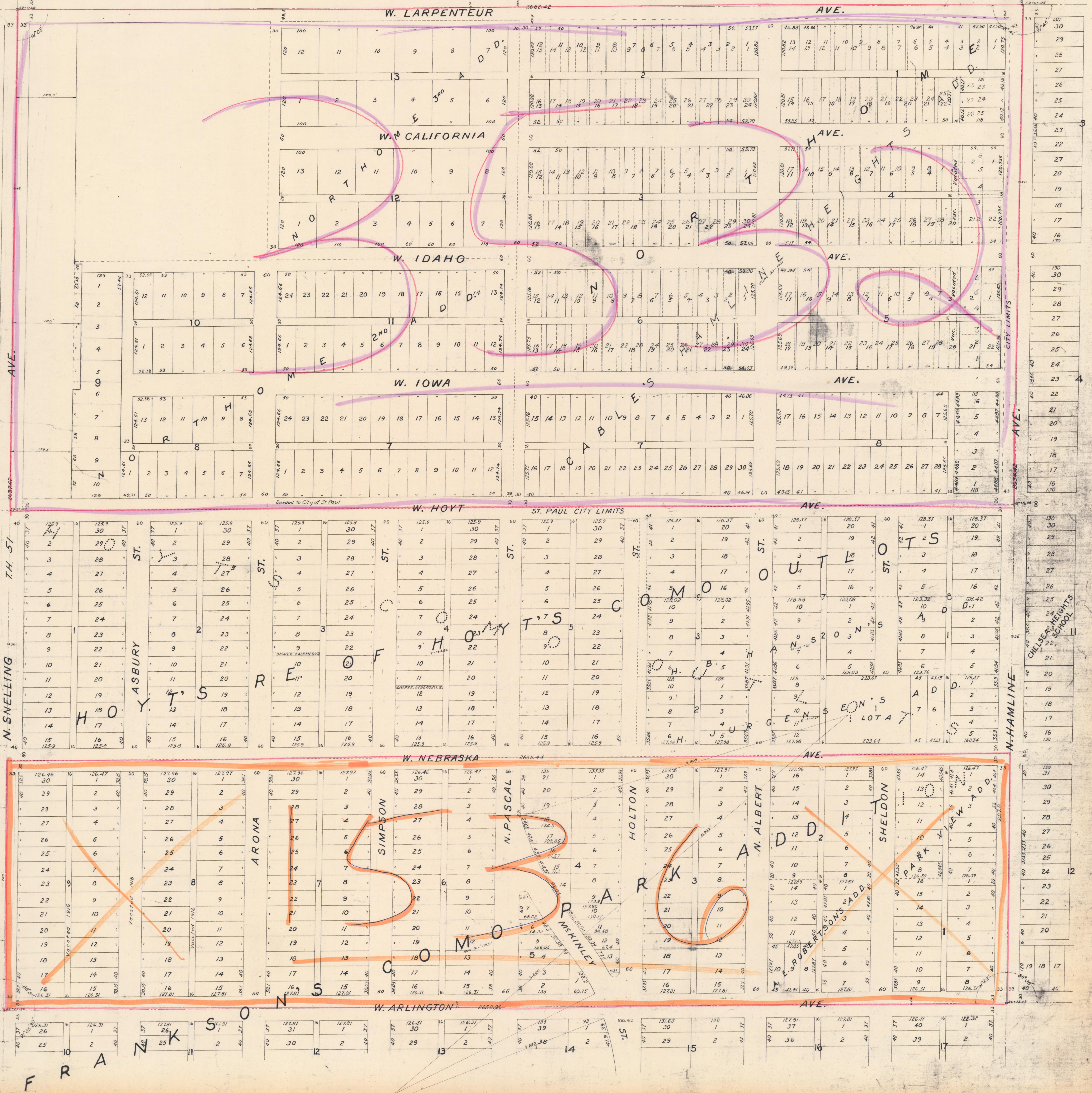

NW 1/4 22-29-23

CHELSEA HEIGHTS SCHOOL

EON'S LOT A

ROBERTSON'S ADD.

SIMPSON

N. PASCAL

HOLTON

M. ALBERT

SHELDON

W. TODD

W. ARRLINGTON

F R A

Z K

S O N

W. ARRLINGTON

ST.

ST.

ST.

ST.

ST.