

N.E. COR. SEC. 16, T29, R23
 Monu. No. 399

Found 1" solid iron down 0.48 ft.
 and set cast iron monu. 6-23-76.

Cast iron in East Bound left turn
 lane of Co. Rd. "B" S. of median 3'±.

Retied monu. 8-13-90

Retied monu. 8-7-02

Retied monu. 8-07-07

Retied C.I.M. down 0.05 ft., 7-13-12

399

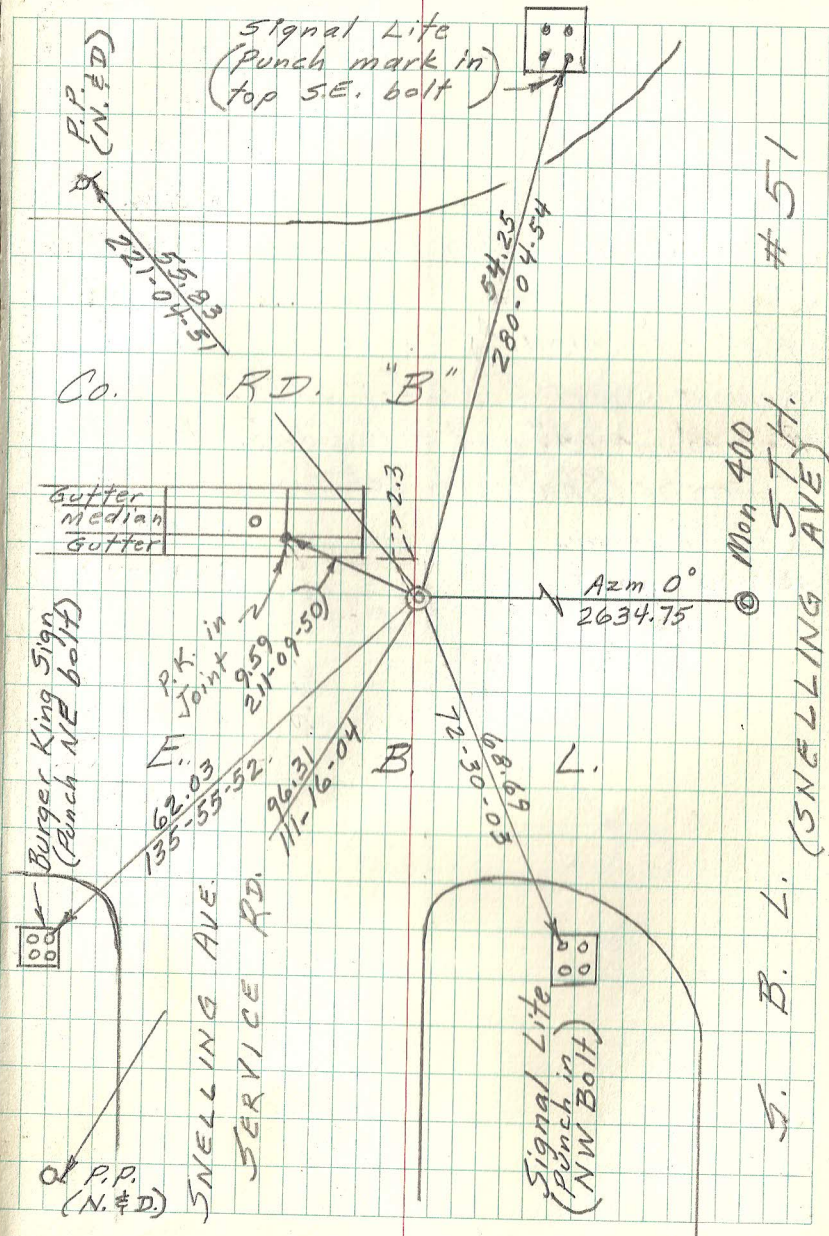

51

ST.H.

S. B. L.

(SNELLING AVE.)