

# CERTIFICATE OF LOCATION OF GOVERNMENT CORNER

SW Corner of Section 19, Township 29, Range 21, 4th P.M.  
STATE OF MINNESOTA, County of Washington

RECEIVED

At the corner location shown on the sketch:

JUN 21 1984

- On 7-30-75 found a 3/4" iron pipe with brass cap. COUNTY OF RAMSEY SURVEYORS OFFICE
- left monument as found,  lowered monument,  removed monument (explain)
- On 8-15-75 placed a Ramsey County replaced I.P. with cast iron monument.

### SKETCH OF REFERENCE TIES

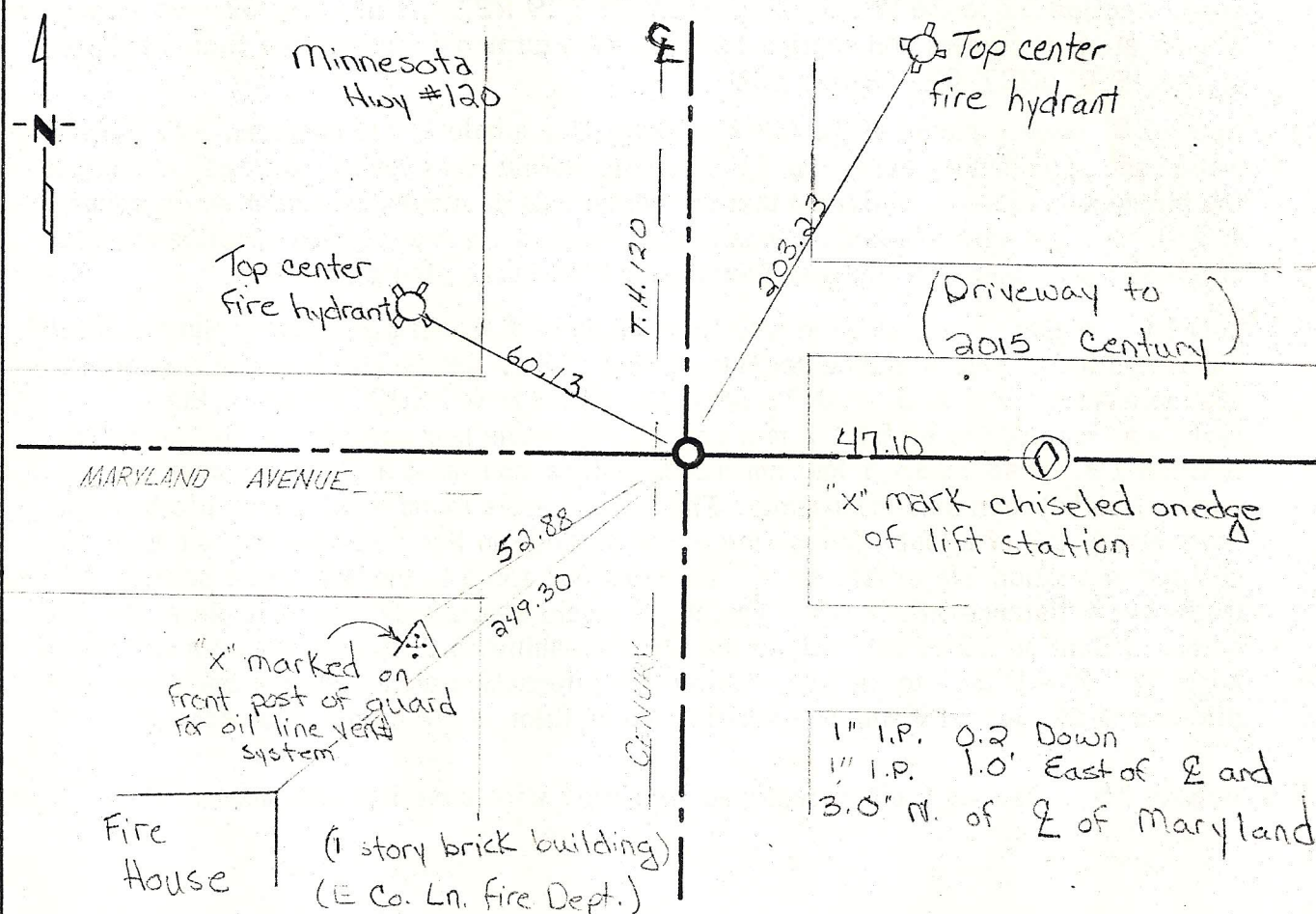

Statement of evidence relative to this corner location is on back of page.

I hereby certify that this document and the data contained herein was prepared by me or under my direct supervision.

Paul A. Johnson 8/18/75  
SIGNATURE DATE

Registration No. 10938

- Land Surveyor,  Professional Engineer
- County Surveyor,  County Engineer

OFFICE OF THE REGISTER OF DEEDS  
County of \_\_\_\_\_

I hereby certify that this document was filed in the Reg. of Deeds office at \_\_\_\_\_ .M. on the \_\_\_\_\_ day of \_\_\_\_\_ A.D., 19 \_\_\_\_\_

Register of Deeds \_\_\_\_\_  
By \_\_\_\_\_, Deputy

DOCUMENT NO. \_\_\_\_\_

MF  
FEB 07 1980

Statement of Evidence:

Section corner common to Sections 19 and 30 T29 R21 and Sections 24 & 25 T29 R22.

- 1847 Original Government survey set a wood post with two bearing trees:  
B Oak 12" S 75° W .13 = 8.58'  
B Oak 18" N 35° E .61 = 40.26'
- 1883 May 24 & 25, Myron Shepard in Survey No. 15 states original corner lost, found pit of B. Oak.
- 1902 An 8 inch square granite monument was placed in the Ramsey County re-survey.
- 1921 April 26-28, L.W. Clarke in Survey No. 348 did a survey in the SW $\frac{1}{4}$  Section 19. Shows on sketch that he used a fence corner for line, fence corner being 33' west of center line. Also shows an X in center line to which he measured to.
- 1943 William G. Klett, locating engineer for the State Highway Department, traversed from the SW corner section 31 to the W $\frac{1}{4}$  corner section 19 T29 R21. Measuring between stone monuments at all  $\frac{1}{4}$  corners and section corners. Also turning the deflection angles at each corner. S.P.6227-02-TH No. 100
- 1973 Sept. 12, Dave Mattson of the MN Hwy Dept. dug a hole 2 feet deep and 1.5 ft. in diameter and searched for evidence of the corner. Nothing was found. A large patching job in the bituminous roadway indicated that the corner was destroyed by recent sewer construction. A 3/4" iron pin with a brass cap was placed flush at the intersection of reference ties obtained from Minnesota Highway Department files in the district 9 office.
- 1975 July 30. Washington County Survey Crew along with the Ramsey County Survey Crew excavated for a spike in the center line of Hwy. 120. Minnesota Highway Department station number 97+85.3 P.O.T. SP 6227-02-TH No. 100 1943. This spike was recorded to be 817.7 feet south of the stone monument at the SW corner of Section 19. Also 1833.1 feet north of the stone monument at the W $\frac{1}{4}$  corner section 30 and on line between said monuments. The survey crews found a spike with cloth ribbon down about .30 of a foot. Measuring to the north to an iron pipe with brass cap at the SW corner section 19 a distance of 816.98 and south to the W $\frac{1}{4}$  corner section 30 stone monument a distance 1833.43. The above record shows a deflection angle at the SW corner of Section 19 of 00° 42' to the left. Washington County measured a deflection angle of 00° 41' 31" to the left. Using this information along with the complete subdivision of Sections 19 and 30, verifies the position of the corner to be correct.
- 1975 August 15, Ramsey County replaced iron pipe with cast iron monument.