

CERTIFICATE OF LOCATION OF GOVERNMENT CORNER

NORTH EAST Corner of Section 30, Township 29, Range 22, _____ P.M.

STATE OF MINNESOTA, County of RAIMSEY

At the corner location shown on the sketch:

- On 5-24-71 found a Nothing
DATE
- left monument as found, lowered monument, removed monument (explain)
- On 5-24-71 placed a 3/4" x 24" IRON PIN
DATE

SKETCH OF REFERENCE TIES

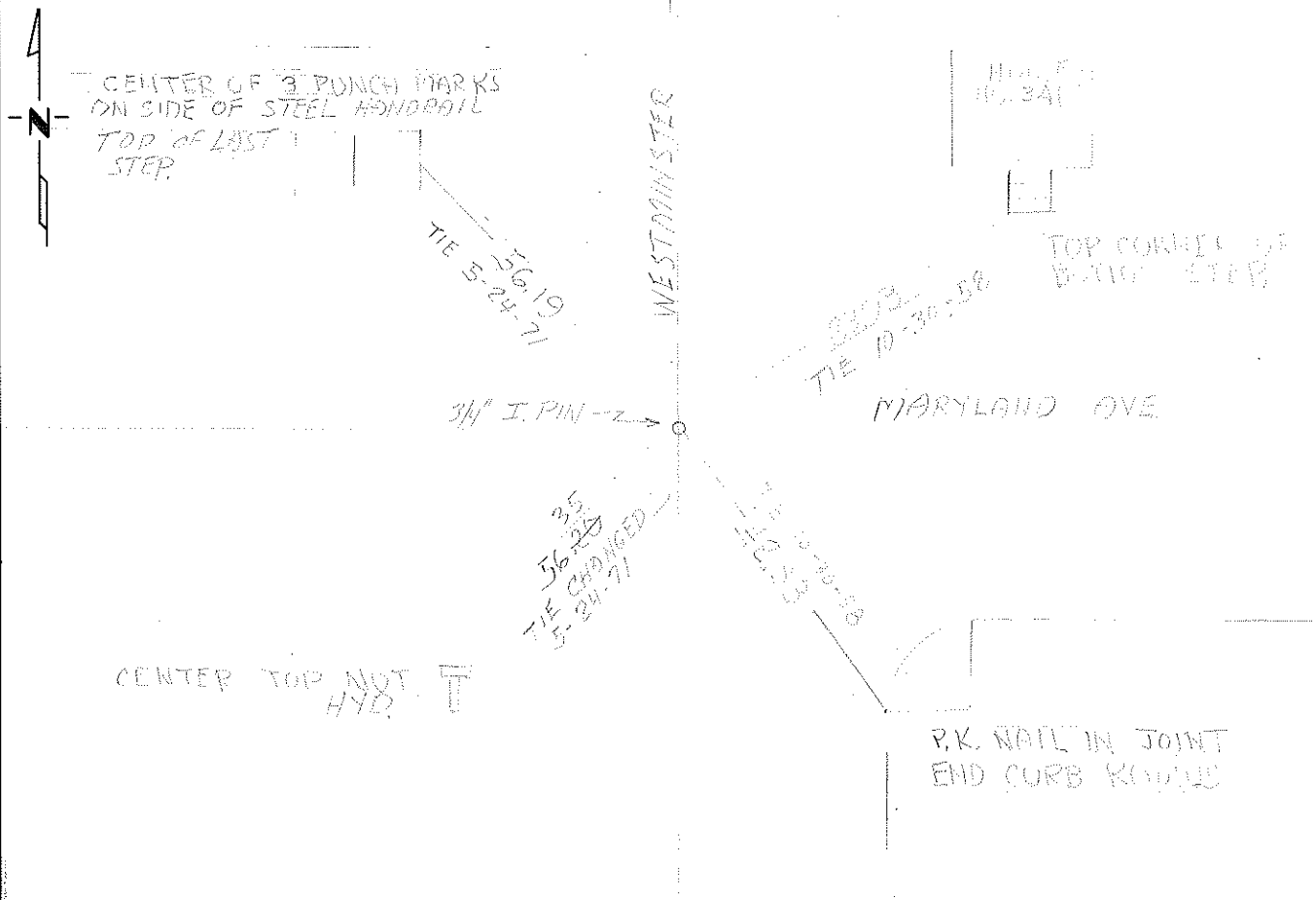

Statement of evidence relative to this corner location is on back of page.

I hereby certify that this document and the data contained herein was prepared by me or under my direct supervision.

SIGNATURE DATE

Registration No. _____

- Land Surveyor, Professional Engineer
- County Surveyor, County Engineer

OFFICE OF THE REGISTER OF DEEDS

County of _____

I hereby certify that this document was filed in the Reg. of Deeds office at _____ .M. on the _____ day of _____ A.D., 19 ____

Register of Deeds _____

By _____, Deputy

DOCUMENT NO. _____

Statement of Evidence:

SP 6280 (T.H. 35-E)

NOTE: STONE MONUMENT WAS REMOVED BY CITY SEWER
CONSTRUCTION IN 1970, USING OLD TIES SLOK & CREW. FIRST
3/4" IRON PIN 0.1 BELOW BIT SURFACE. OLD TIES WERE MADE
BY JIM CHANES 10-30-58 AT WHICH TIME THERE WAS A
GRANITE MONUMENT IMPRINT. J.E.C.