

CERTIFICATE OF LOCATION OF GOVERNMENT CORNER

EAST QUARTER Corner of Section 13, Township 29N, Range 22W, 4th P.M.

STATE OF MINNESOTA, County of RAMSEY AND WASHINGTON

At the corner location shown on the sketch:

On Sept 13, 1973 found a 8 in. square granite monument 0.6 ft below the
DATE bituminous surface.

left monument as found, lowered monument, removed monument (explain)

On Sept 13, 1973 placed a 3/4 in. iron pin flush.
DATE

CIM 1979 RAMSEY CO. & WASH. CO.

SKETCH OF REFERENCE TIES

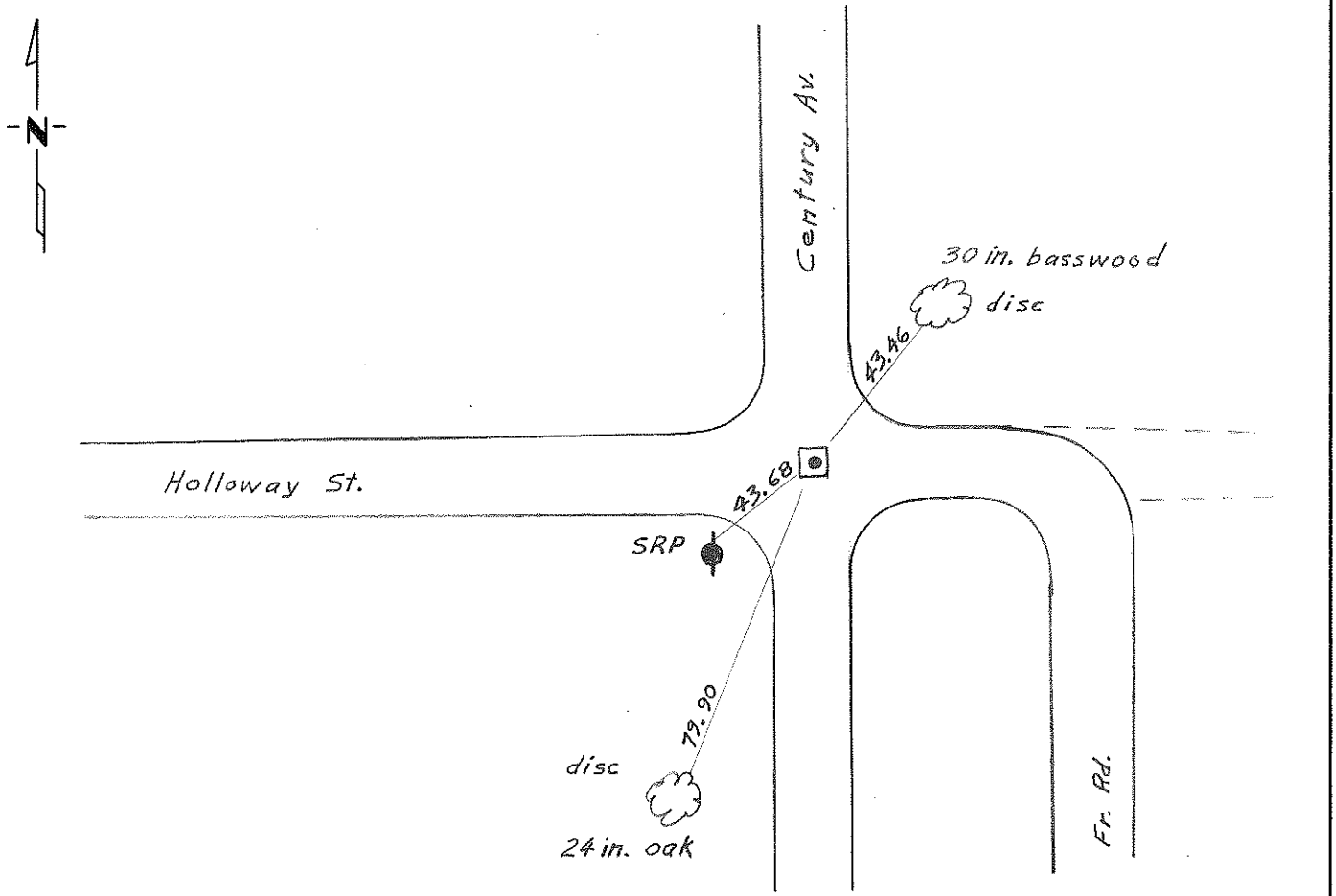

Statement of evidence relative to this corner location is on back of page.

I hereby certify that this document and the data contained herein was prepared by me or under my direct supervision.

SIGNATURE DATE

Registration No. _____

Land Surveyor, Professional Engineer

County Surveyor, County Engineer

OFFICE OF THE REGISTER OF DEEDS

County of _____

I hereby certify that this document was filed in the Reg. of Deeds office at _____ .M. on the _____ day of _____ A.D., 19 _____

Register of Deeds _____

By _____, Deputy

DOCUMENT NO. _____