

CERTIFICATE OF LOCATION OF GOVERNMENT CORNER

EAST QUARTER Corner of Section 2, Township 29N, Range 22W, 4th P.M.
STATE OF MINNESOTA, County of RAMSEY

At the corner location shown on the sketch:

- On MAY 23, 1974 found a 3/4 in. iron pipe down 0.5 ft.
DATE
- left monument as found, lowered monument, removed monument (explain)
- On MAY 23, 1974 placed a Cast iron monument flush in the same location as the
DATE 3/4 in. iron pipe.

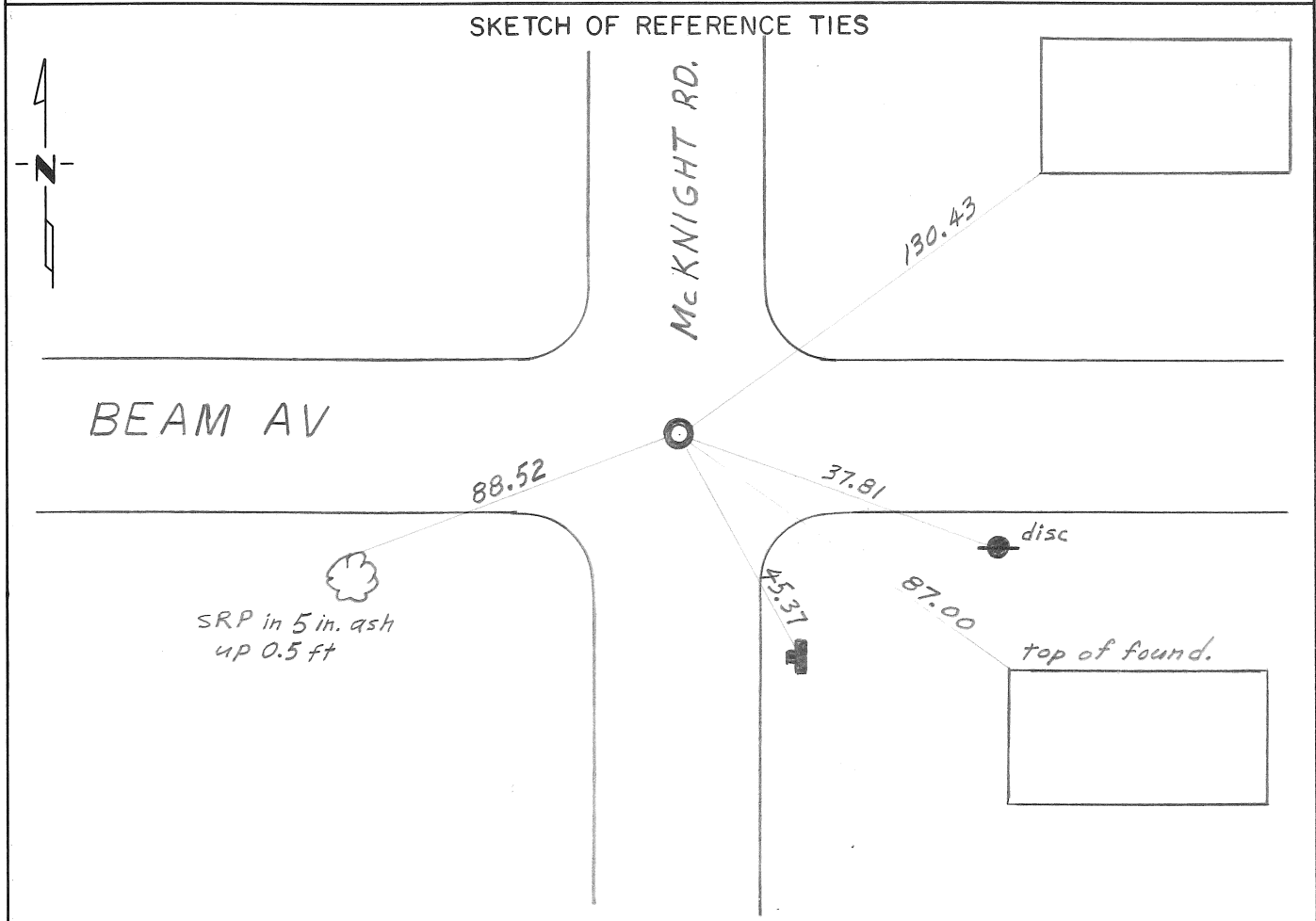

Statement of evidence relative to this corner location is on back of page.

I hereby certify that this document and the data contained herein was prepared by me or under my direct supervision.

Donald H. Campbell 1 Aug 74
SIGNATURE DATE

Registration No. 5712

- Land Surveyor, Professional Engineer
- County Surveyor, County Engineer

OFFICE OF THE REGISTER OF DEEDS

County of _____

I hereby certify that this document was filed in the Reg. of Deeds office at _____ .M. on the _____ day of _____ A.D., 19 ____

Register of Deeds _____

By _____, Deputy

DOCUMENT NO. _____

Statement of Evidence: EAST QUARTER CORNER OF SECTION 2, T29N, R22W, 4th PM

- 1847 A wood post was placed in the Public Land Survey.
- 1902 A granite monument was placed in the Ramsey County re-survey.
- 1974 On May 23 Dave Mattson of the Minnesota Highway Department found a $\frac{3}{4}$ in. iron pipe down 0.5 ft. A hole was dug 3 ft deep and 2 ft in diameter. No evidence was found. The granite monument was apparently destroyed by sewer construction. A cast iron monument was placed in the same location as the $\frac{3}{4}$ in. iron pipe.